

Lovibond® Water Testing

Tintometer® Group



Hardness Calcium & Total Drop Test Kit

561700270

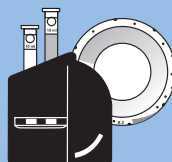
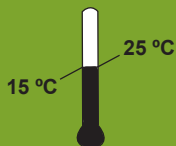

Hardness Calcium & Total Drop Test Kit

Note:

1. Further instructions can be found with the corresponding product.

Hardness Calcium

561700270

5 - 600 mg/L CaCO₃

Material

EN

Reagents	Packaging Unit	Part Number
Hardness Calcium Buffer CH2	65 mL	56L014465
Hardness Calcium Indicator CH1P	Powder / 20 g	56P021620
Hardness LR Titrant TH3	65 mL	56L016265
Hardness HR Titrant TH4	65 mL	56L014565
Hardness Total Indicator TH1P	Powder / 40 g	56P028340
Hardness Total Buffer TH2	65 mL	56L016065

The following accessories are required.

Accessories	Packaging Unit	Part Number
Syringe, plastic, 20 mL	1 pc.	56A006501
Titration jar with cap, plastic, 60 mL	1 pc.	56A006701

Sampling

Select the sample volume from the table according to the expected measuring range and read off the factor to calculate the result.

Expected Range	Titrant used	Sample Size	Factor
5-15 mg/L	Hardness LR Titration TH3	40 mL	0.5
10-30 mg/L	Hardness LR Titration TH3	20 mL	1
20-60 mg/L	Hardness LR Titration TH3	10 mL	2
50-150 mg/L	Hardness HR Titration TH4	40 mL	5
100-300 mg/L	Hardness HR Titration TH4	20 mL	10
200-600 mg/L	Hardness HR Titration TH4	10 mL	20

Determination of Hardness Calcium



Attention! Select the appropriate sample volume according to the instructions in the chapter Sampling.



Add **4** drops of **Hardness Calcium Buffer CH2** per **10 mL** of sample.

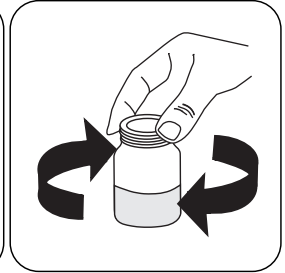

Swirl to mix.

EN

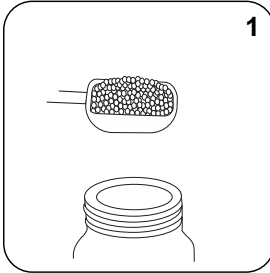

Add **1** measuring scoop(s) **Hardness Calcium Indicator CH1P**.



Swirl to mix.



The sample will turn **wine red**.

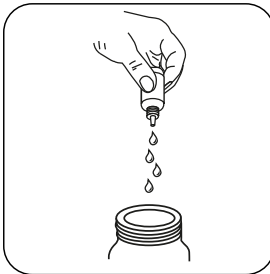

Attention! Record the number of drops that will be added.

Note: Make sure to swirl the jar after adding each drop!

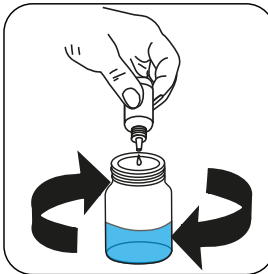

Add **Hardness LR Titrant TH3** or **Hardness HR Titrant TH4** drop by drop to the sample until colouration turns from **wine red** to **blue**.

Calculate test result: Total Hardness (as CaCO₃) mg/L = Number of drops x factor (see table)

Hardness, total**56I700280****5 - 600 mg/L CaCO₃**

EN

Material

Reagents	Packaging Unit	Part Number
Hardness Total Buffer TH2	65 mL	56L016065
Hardness Total Indicator TH1P	Powder / 40 g	56P028340
Hardness LR Titrant TH3	65 mL	56L016265
Hardness HR Titrant TH4	65 mL	56L014565

The following accessories are required.

Accessories	Packaging Unit	Part Number
Syringe, plastic, 20 mL	1 pc.	56A006501
Titration jar with cap, plastic, 60 mL	1 pc.	56A006701

Notes

1. Colours may vary depending on sample and test conditions.
2. More than 1 ppm copper in the sample will prevent the pure blue endpoint from occurring.
3. To remove copper interference, add 1 drop of Iron Reagent FE6 before the addition of Hardness Total Buffer TH2. Iron Reagent FE6 is not supplied as standard in the hardness test pack, but can be purchased separately. (56L006365)

Sampling

Select the sample volume from the table according to the expected measuring range and read off the factor to calculate the result.

Expected Range	Titrant used	Sample Size	Factor
5-15 mg/L CaCO ₃	Hardness LR Titrant TH3	40 mL	0.5
10-30 mg/L CaCO ₃	Hardness LR Titrant TH3	20 mL	1
20-60 mg/L CaCO ₃	Hardness LR Titrant TH3	10 mL	2
50-150 mg/L CaCO ₃	Hardness HR Titrant TH4	40 mL	5
100-300 mg/L CaCO ₃	Hardness HR Titrant TH4	20 mL	10
200-600 mg/L CaCO ₃	Hardness HR Titrant TH4	10 mL	20

EN

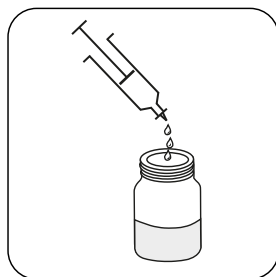

Attention! Select the appropriate sample volume according to the instructions in the chapter Sampling.

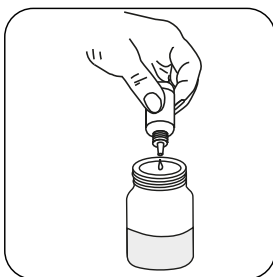

Add **4** drops of **Hardness Total Buffer TH2** per **10 mL** of sample.

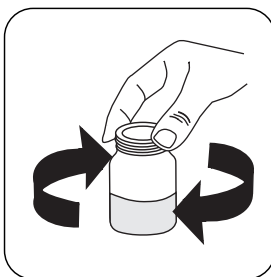

Swirl to mix.

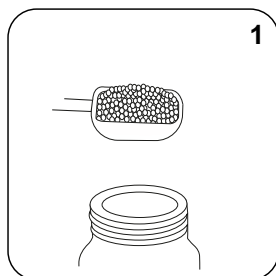

Add **1** measuring scoop(s) **Hardness Total Indicator TH1P**.

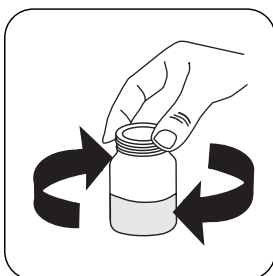

Swirl to mix.



The sample will turn **wine red**.

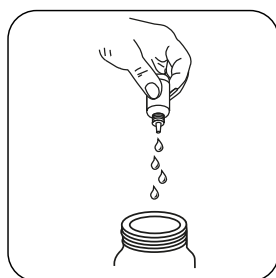

Attention! Record the number of drops that will be added.

Note: Make sure to swirl the jar after adding each drop!

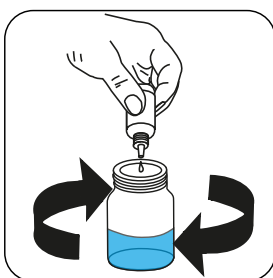

Add **Hardness LR Titrant TH3** or **Hardness HR Titrant TH4** drop by drop to the sample until colouration turns from **wine red** to **blue**.

Calculate test result: Total Hardness (as CaCO₃) mg/L = Number of drops x factor (see table)

Tintometer GmbH

Lovibond® Water Testing
Schleefstraße 8-12
44287 Dortmund
Tel.: +49 (0)231/94510-0
sales@lovibond.com
www.lovibond.com
Germany

Tintometer South East Asia

Unit B-3-12, BBT One Boulevard,
Lebuh Nilam 2, Bandar Bukit Tinggi,
Klang, 41200, Selangor D.E
Tel.: +60 (0)3 3325 2285/6
Fax: +60 (0)3 3325 2287
lovibond.asia@tintometer.com
www.lovibond.com
Malaysia

Tintometer India Pvt. Ltd.

Door No: 7-2-C-14, 2nd, 3rd & 4th Floor
Sanathnagar Industrial Estate,
Hyderabad, 500018
Telangana
Tel: +91 (0) 40 23883300
Toll Free: 1 800 599 3891/ 3892
indiaoffice@lovibond.in
www.lovibondwater.in
India

The Tintometer Limited

Lovibond House
Sun Rise Way
Amesbury, SP4 7GR
Tel.: +44 (0)1980 664800
Fax: +44 (0)1980 625412
sales@lovibond.uk
www.lovibond.com
UK

Tintometer Brazil

Caixa Postal: 271
CEP: 13201-970
Jundiaí – SP
Tel.: +55 (11) 3230-6410
sales@tintometer.com.br
www.lovibond.com.br
Brazil

Tintometer Spain

Postbox: 24047
08080 Barcelona
Tel.: +34 661 606 770
sales@tintometer.es
www.lovibond.com
Spain

Tintometer China

Room 1001, China Life Tower
16 Chaoyangmenwai Avenue,
Beijing, 100020
Tel.: +86 10 85251111 App. 330
Fax: +86 10 85251001
chinaoffice@tintometer.com
www.lovibond.com
China

Tintometer Inc.

6456 Parkland Drive
Sarasota, FL 34243
Tel: 941.756.6410
Fax: 941.727.9654
sales@lovibond.us
www.lovibond.com
USA



Technical changes without notice
Printed in Germany 05/23

No.: 561700270

Lovibond® and Tintometer® are Trademarks of
the Tintometer Group of Companies

