

Conductivity**SD 335****0 - 200 mS/cm**

The following accessories are required.

Accessories	Packaging Unit	Part Number
LC 12 for SD 320 / SD 325 Con, up to 200 mS/cm	1 pc.	19805040

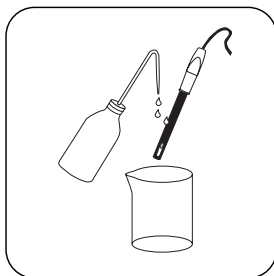

Rinse the electrode with distilled or deionised water and then with the sample.

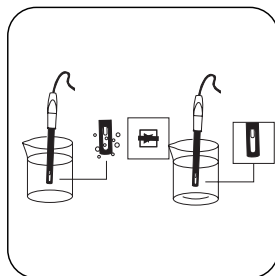

Immerse the measuring cell in the sample. During measurement, ensure that there are no air bubbles on the electrode surface and that the electrode, as well as the temperature sensor, are sufficiently surrounded by the sample.



The measurement value can now be read off from the display. In the parameter configuration you can change the conductivity to TDS or salinity if required.