

Lovibond® Water Testing

Tintometer® Group



Manual of Methods

MD50 • MD150

Chlorine Dioxide

EN MD50 Photometer

Page 4

ES Fotómetro MD50

Página 20

PT Fotómetro MD50

Página 36

NL MD50 Fotometer

Zijde 52

RU Фотометр MD50

Страница 68

DE MD50 Photometer

Seite 12

FR MD50 Photomètre

Page 28

IT Fotometro MD50

Pagina 44

TR MD50 fotometre

Sayfa 60

ZH MD50 光度计

Page 76

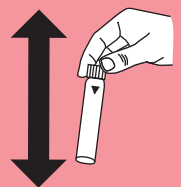
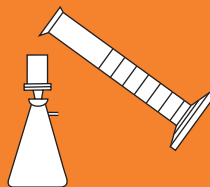

KS4.3 T / 20

Method name

Method number

Bar code for the detection of the methods

Measuring range

20

S:4.3

Chemical Method

Display in the MD 100 / MD 110 / MD 200

Instrument specific information

The test can be performed on the following devices. In addition, the required cuvette and the absorption range of the photometer are indicated.

Instrument Type	Cuvette	λ	Measuring Range
MD 200, MD 600, MD 610, MD 640, MultiDirect, PM 620, PM 630	ø 24 mm	610 nm	0.1 - 4 mmol/l K _{S4.3}
SpectroDirect, XD 7000, XD 7500	ø 24 mm	615 nm	0.1 - 4 mmol/l K _{S4.3}

Material

Required material (partly optional):

Reagents	Packaging Unit	Part Number
Alka-M-Photometer	Tablet / 100	513210BT
Alka-M-Photometer	Tablet / 250	513211BT

Application List

- Waste Water Treatment
- Drinking Water Treatment
- Raw Water Treatment

Notes

1. The terms Alkalinity-m, m-Value, total alkalinity and Acid demand to K_{S4.3} are identical.
2. For accurate results, exactly 10 ml of water sample must be used for the test.

Language codes ISO 639-1

Revision status

EN Handbook of Methods 01/20

Performing test procedure

Implementation of the provision Acid capacity $K_{S4.3}$ with Tablet

Select the method on the device

For this method, no ZERO measurements are to be carried out with the following devices: XD 7000, XD 7500



Fill 24 mm vial with **10 ml sample**.



Close vial(s).



Place **sample vial** in the sample chamber. • Pay attention to the positioning.

• • •



Dissolve tablet(s) by inverting.



Place **sample vial** in the sample chamber. • Pay attention to the positioning.



Press the **TEST** (XD: **START**) button.

The result in Acid Capacity $K_{S4.3}$ appears on the display.

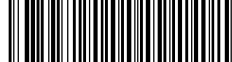

Chlorine dioxide PP

M122

0.04 - 3.8 mg/L ClO₂

CLO2

DPD

EN

Material

Required material (partly optional):

Reagents	Packaging Unit	Part Number
Chlorine Free DPD F10	Powder / 100 pc.	530100
Chlorine Free DPD F10	Powder / 1000 pc.	530103
Glycine ⁹⁾	Tablet / 100	512170BT
Glycine ⁹⁾	Tablet / 250	512171BT
VARIO Glycine Reagent 10 %, 29 ml	29 mL	532210

Sampling

1. When preparing the sample, outgassing, e.g. through the pipette or shaking, must be avoided.
2. The analysis must take place immediately after taking the sample.

Preparation

1. Cleaning of vials:
As many household cleaners (e.g. dishwasher detergent) contain reducing substances, this can lead to lower results with the determination of Chlorine dioxide. To avoid measurement errors, the glassware used should be free of chlorine consumption. To achieve this, all glassware should be placed in a sodium hypochlorite solution (0.1 g/L) for one hour and then rinsed thoroughly with deionised water.
2. Strong alkaline or acidic water samples must be adjusted between pH 6 and pH 7 before the analysis (use 0.5 mol/l Sulphuric acid or 1 mol/l Sodium hydroxide).

Determination of Chlorine Dioxide, in absence of chlorine with powder packs

Select the method on the device.

In addition, choose the test: without Chlorine

For this method, a ZERO measurement does not have to be carried out every time on the following devices: XD 7000, XD 7500



Fill 24 mm vial with **10 mL sample**.

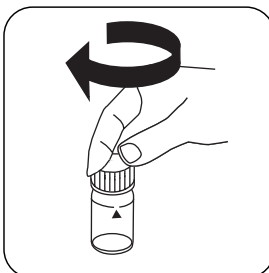

Close vial(s).

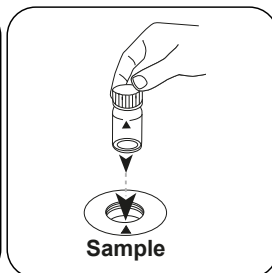

Place **sample vial** in the sample chamber. Pay attention to the positioning.

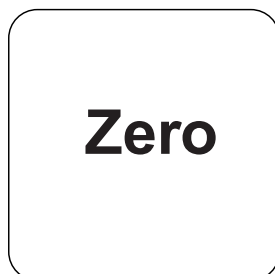

Press the **ZERO** button.

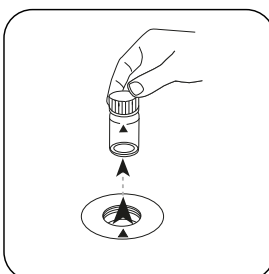

Remove the vial from the sample chamber.

For devices that require **no ZERO measurement**, start here.

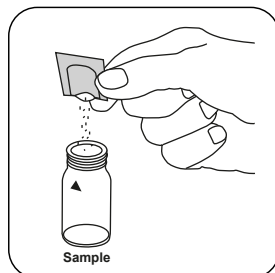

Add **Chlorine FREE-DPD / F10 powder pack**.

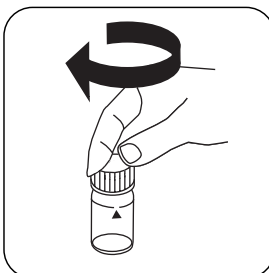

Close vial(s).

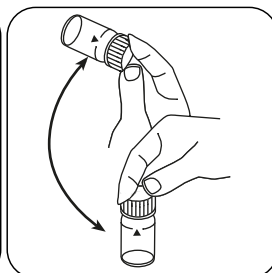

Invert several times to mix the contents (20 sec.).

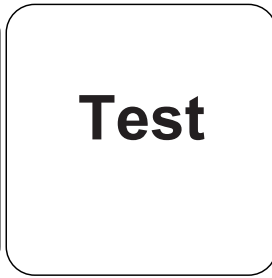
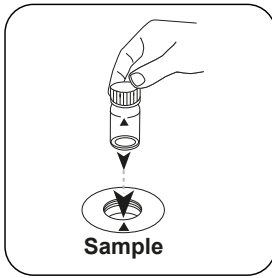

Place **sample vial** in the sample chamber. Pay attention to the positioning.

Press the **TEST** (XD: **START**) button.

The result in mg/L Chlorine Dioxide appears on the display.

Determination of Chlorine Dioxide, in presence of chlorine with powder packs

Select the method on the device.

In addition, choose the test: in presence of Chlorine

For this method, a ZERO measurement does not have to be carried out every time on the following devices: XD 7000, XD 7500



Fill 24 mm vial with **10 mL sample**.

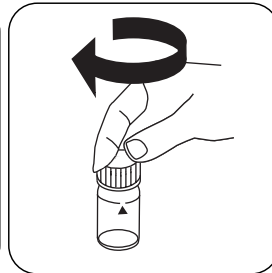

Close vial(s).

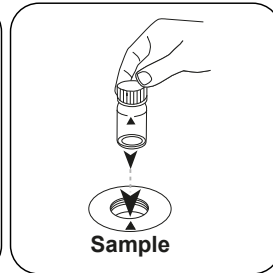

Place **sample vial** in the sample chamber. Pay attention to the positioning.

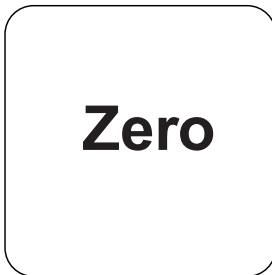

Press the **ZERO** button.

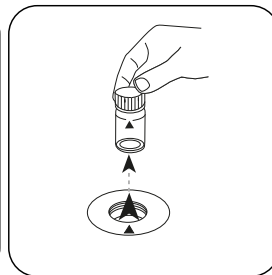

Remove the vial from the sample chamber.

For devices that require **no ZERO measurement**, **start here**.

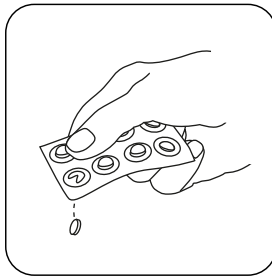

Add **GLYCINE** tablet.

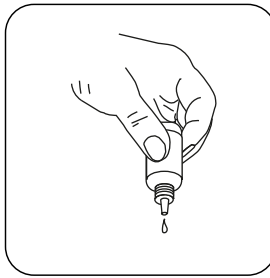

or add 4 drops **GLYCINE** Reagent.

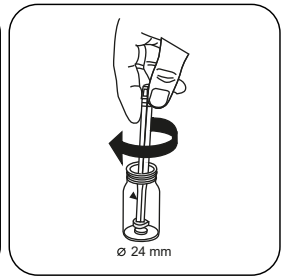

Crush tablet(s) by rotating slightly.

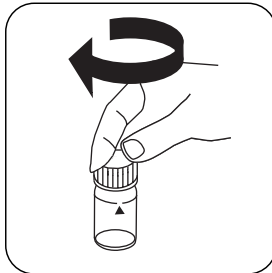

Close vial(s).

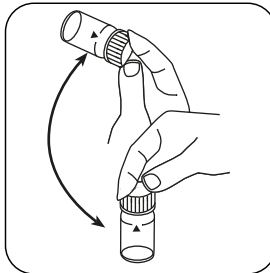

Dissolve tablet(s) by inverting.

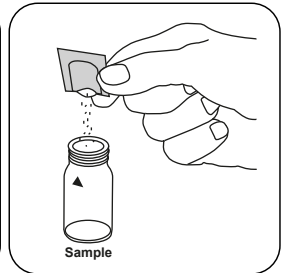

Add **Chlorine-Free-DPD/ F10** powder pack.

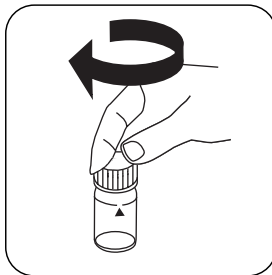

Close vial(s).

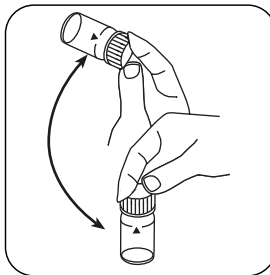

Invert several times to mix the contents (20 sec.).

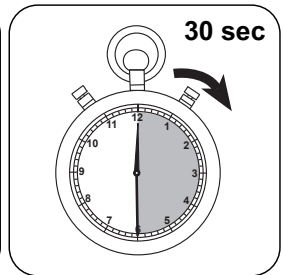

Wait for **30 second(s)** reaction time.

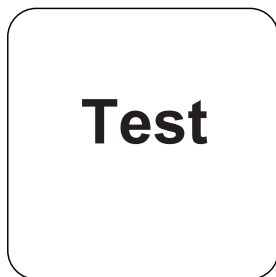

EN

Place **sample vial** in the sample chamber. Pay attention to the positioning.

Press the **TEST** (XD: **START**) button.

The result in mg/L Chlorine Dioxide appears on the display.



Chemical Method

DPD

Appendix

Interferences

Persistent Interferences

1. All oxidising agents in the samples lead to higher results.

Removeable Interferences

1. Concentrations above 3.8 mg/L chlorine dioxide can lead to results within the measuring range of up to 0 mg/L. In this case, the water sample must be diluted with water that is free from chlorine dioxide. 10 ml of the diluted sample should be mixed with the reagent and the measurement taken again (plausibility test).

Derived from

DIN 38408, Section 5

⁹ additionally required for determination of bromine, chlorine dioxide and ozone in the presence of chlorine

EN

KS4.3 T / 20

Methoden Name

Methodennummer

Barcode zur Methodenerkennung

Messbereich

$K_{S_{4.3} T}$
 0,1 - 4 mmol/l $K_{S_{4.3}}$
 Säure / Indikator

20
 S:4.3

Displayanzeige im MD 100 MD 110 / MD 200

Chemische Methode

Instrumentenspezifische Informationen

Der Test kann auf den folgenden Geräten durchgeführt werden. Zusätzlich sind die benötigte Küvette und der Absorptionsbereich der Photometer angegeben.

Geräte	Küvette	λ	Messbereich
MD 200, MD 600, MD 610, MD 640, MultiDirect, PM 620, PM 630	ø 24 mm	610 nm	0,1 - 4 mmol/l $K_{S_{4.3}}$
SpectroDirect, XD 7000, XD 7500	ø 24 mm	615 nm	0,1 - 4 mmol/l $K_{S_{4.3}}$

Material

Benötigtes Material (zum Teil optional):

Reagenzien	Form/Menge	Bestell-Nr.
Alka-M-Photometer	Tablette / 100	513210BT
Alka-M-Photometer	Tablette / 250	513211BT

Anwendungsbereich

- Abwasserbehandlung
- Trinkwasseraufbereitung
- Rohwasserbehandlung

Anmerkungen

1. Die Begriffe Alkalität-m, m-Wert, Gesamtalkalität und Säurekapazität $K_{S_{4.3}}$ sind identisch.
2. Die exakte Einhaltung des Probevolumens von 10 ml ist für die Genauigkeit des Analyseergebnisses entscheidend.

Sprachkürzel nach ISO 639-1

Revisionsstand

DE Methodenhandbuch 01/20

Durchführung der
Messung**Durchführung der Bestimmung Säurekapazität $K_{s4,3}$ mit Tablette**

Die Methode im Gerät auswählen.

Für diese Methode muss bei folgenden Geräten keine ZERO-Messung durchgeführt werden: XD 7000, XD 7500

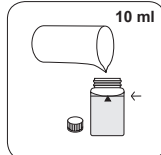
24-mm-Küvette mit **10 ml Probe** füllen.

Küvette(n) verschließen.

Die **Probeküvette** in den Messschacht stellen. Positionierung beachten.

• • •

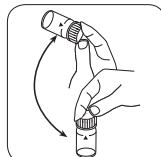

Tablette(n) durch Umschwenken lösen.

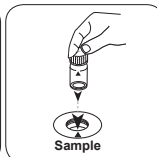
Die **Probeküvette** in den Messschacht stellen. Positionierung beachten.Taste **TEST** (XD: **START**) drücken.In der Anzeige erscheint das Ergebnis als Säurekapazität $K_{s4,3}$.

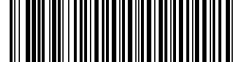

Chlordioxid PP

M122

0,04 - 3,8 mg/L ClO₂

CLO2

DPD

DE

Material

Benötigtes Material (zum Teil optional):

Reagenzien	Form/Menge	Bestell-Nr.
Chlorine Free DPD F10	Pulver / 100 St.	530100
Chlorine Free DPD F10	Pulver / 1000 St.	530103
Glycine ⁹⁾	Tablette / 100	512170BT
Glycine ⁹⁾	Tablette / 250	512171BT
VARIO Glycin Reagenz 10%, 29 ml	29 mL	532210

Probenahme

1. Bei der Probenvorbereitung muss das Ausgasen, z.B. durch Pipettieren und Schütteln, vermieden werden.
2. Die Analyse muss unmittelbar nach der Probenahme erfolgen.

Vorbereitung

1. Reinigung der Küvetten:
Da viele Haushaltsreiniger (z.B. Geschirrspülmittel) reduzierende Stoffe enthalten, kann es bei der Bestimmung von Chlordioxid zu Minderbefunden kommen. Um diesen Messfehler auszuschließen, sollten die Glasgeräte chlorzehrungsfrei sein. Dazu werden die Glasgeräte für eine Stunde unter Natriumhypochloritlösung (0,1 g/L) aufbewahrt und danach gründlich mit VE-Wasser (Vollentsalztes Wasser) gespült.
2. Stark alkalische oder saure Wässer müssen vor der Analyse in einen pH-Bereich zwischen 6 und 7 gebracht werden (mit 0,5 mol/l Schwefelsäure bzw. 1 mol/l Natronlauge).

Durchführung der Bestimmung Chlordioxid, in Abwesenheit von Chlor, mit Pulverpäckchen

Die Methode im Gerät auswählen.

Wählen Sie zudem die Bestimmung: ohne Chlor

Für diese Methode muss bei folgenden Geräten nicht jedes mal eine ZERO-Messung durchgeführt werden: XD 7000, XD 7500



24-mm-Küvette mit **10 mL Probe** füllen.

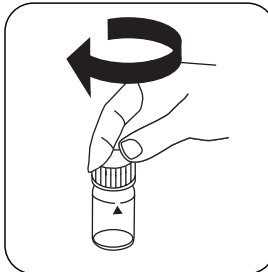

Küvette(n) verschließen.

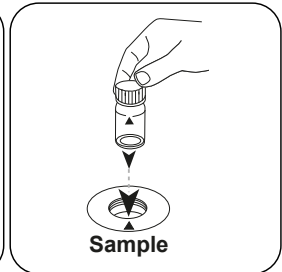

Die **Probenküvette** in den Messschacht stellen. Positionierung beachten.

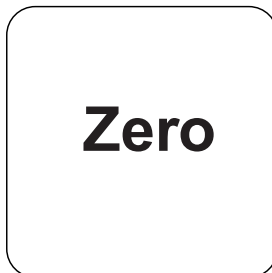

Taste **ZERO** drücken.

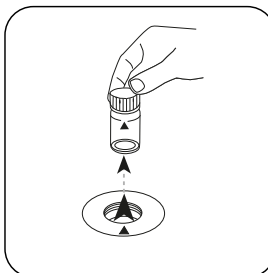

Küvette aus dem Messschacht nehmen.

Bei Geräten, die **keine ZERO-Messung** erfordern, **hier beginnen**.

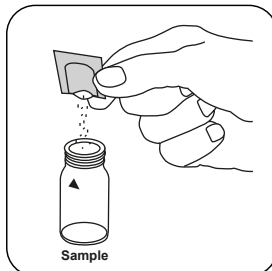

Ein **Chlorine FREE-DPD / F10 Pulverpäckchen** zugeben.

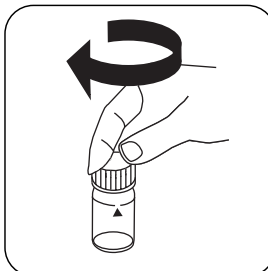

Küvette(n) verschließen.

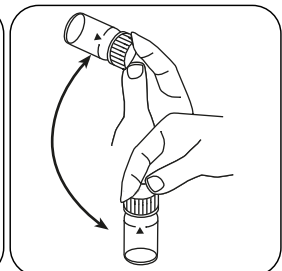

Inhalt durch Umschwenken mischen (20 Sek.).

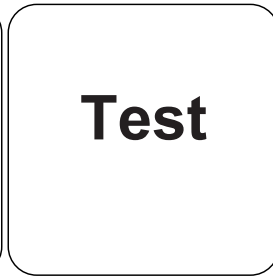
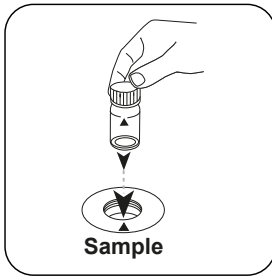

DE

Die **Probeküvette** in den Messschacht stellen. Positionierung beachten.

Taste **TEST** (XD: **START**) drücken.

In der Anzeige erscheint das Ergebnis in mg/L Chlordioxid.

Durchführung der Bestimmung Chlordioxid, in Anwesenheit von Chlor, mit Pulverpäckchen

Die Methode im Gerät auswählen.

Wählen Sie zudem die Bestimmung: neben Chlor

Für diese Methode muss bei folgenden Geräten nicht jedes mal eine ZERO-Messung durchgeführt werden: XD 7000, XD 7500



24-mm-Küvette mit **10 mL Probe** füllen.

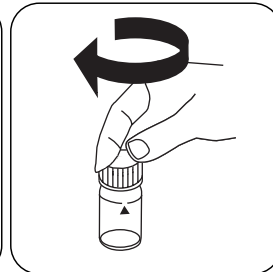

Küvette(n) verschließen.

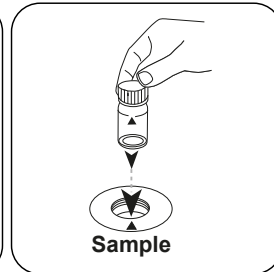

Die **Probeküvette** in den Messschacht stellen. Positionierung beachten.

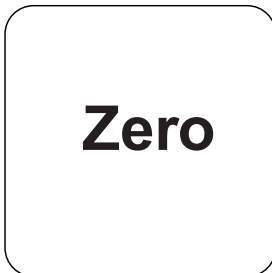

Taste **ZERO** drücken.

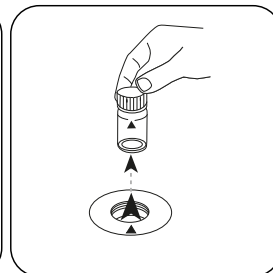

Küvette aus dem Messschacht nehmen.

Bei Geräten, die **keine ZERO-Messung** erfordern, **hier beginnen**.

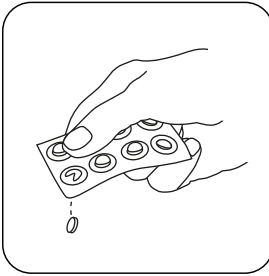

Eine **GLYCINE** Tablette zugeben.

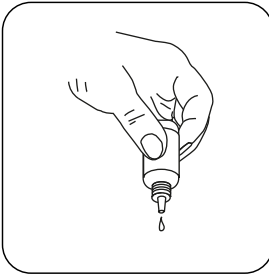

oder 4 Tropfen GLYCINE Reagenz zugeben.

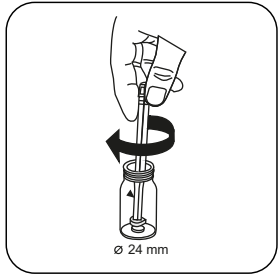

Tablette(n) unter leichter Drehung zerdrücken.

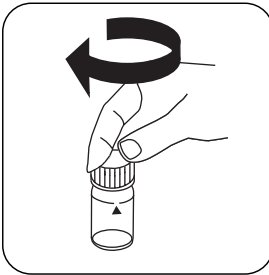

Küvette(n) verschließen.

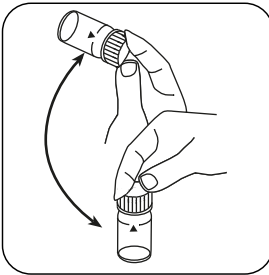

Tablette(n) durch Umschwenken lösen.

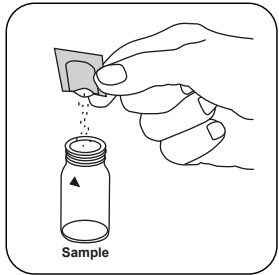

Ein **Chlorine-Free-DPD/ F10 Pulverpäckchen** zugeben.

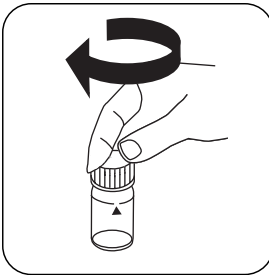

Küvette(n) verschließen.

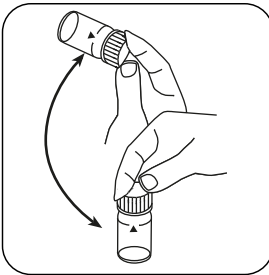

Inhalt durch Umschwenken mischen (20 Sek.).

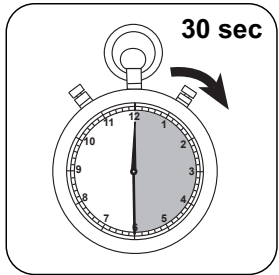

30 Sekunden Reaktionszeit abwarten.

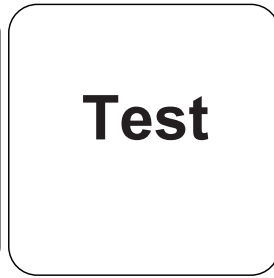
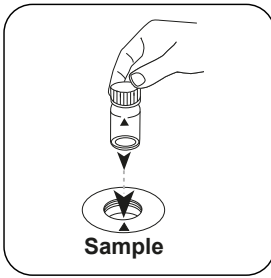

DE

Die **Probenküvette** in den Messschacht stellen. Positionierung beachten.

Taste **TEST** (XD: **START**) drücken.

In der Anzeige erscheint das Ergebnis in mg/L Chlordioxid.



Chemische Methode

DPD

Appendix

Störungen

Permanente Störungen

1. Alle in den Proben vorhandenen Oxidationsmittel führen zu Mehrbefunden.

Ausschließbare Störungen

1. Konzentrationen über 3,8 mg/L Chlordioxid können zu Ergebnissen innerhalb des Messbereiches bis hin zu 0 mg/L führen. In diesem Fall ist die Wasserprobe mit chlordioxidfreiem Wasser zu verdünnen. 10 ml der verdünnten Probe werden mit Reagenz versetzt und die Messung wiederholt (Plausibilitätstest).

Abgeleitet von

DIN 38408, Teil 5

⁹ Hilfsreagenz, wird zusätzlich für die Bestimmung Brom, Chlordioxid bzw. Ozon benötigt bei Anwesenheit von Chlor

DE

KS4.3 T / 20



Nombre del método

Número de método

Código de barras para reconocer el método

Rango de medición

$K_{S4.3} T$
0.1 - 4 mmol/l $K_{S4.3}$
Ácido / Indicador

20
S:4.3

Método químico

Indicación en la pantalla de MD 100 / MD 110 / MD 200

Información específica del instrumento

La prueba puede realizarse en los siguientes dispositivos. Además, se muestran la cubeta requerida y el rango de absorción del fotómetro.

Dispositivos	Cubeta	λ	Rango de medición
MD 200, MD 600, MD 610, MD 640, MultiDirect, PM 620, PM 630	\varnothing 24 mm	610 nm	0.1 - 4 mmol/l $K_{S4.3}$
SpectroDirect, XD 7000, XD 7500	\varnothing 24 mm	615 nm	0.1 - 4 mmol/l $K_{S4.3}$

Material

Material requerido (parcialmente opcional):

Título	Unidad de embalaje	Referencia No
Fotómetro alca-M	Tabletas / 100	513210BT
Fotómetro alca-M	Tabletas / 250	513211BT

Lista de aplicaciones

- Tratamiento de aguas residuales
- Tratamiento de aguas potables
- Tratamiento de aguas de aporte

Notas

1. Las definiciones de alcalinidad-m, valor-m y capacidad ácida $K_{S4.3}$ son idénticas.
2. Añadir un volumen de muestra de exactamente 10 ml, ya que este volumen influye de forma decisiva en la exactitud del resultado.

Códigos de idioma ISO 639-1

Estado de revisión

ES Manual de Métodos 01/20

Realización de la determinación

Ejecución de la determinación Capacidad ácida $K_{s4.3}$ con tableta

Seleccionar el método en el aparato.

Para este método no es necesario realizar medición CERO en los aparatos siguientes: XD 7000, XD 7500



Llenar la cubeta de 24 mm con **10 ml de muestra**.



Cerrar la(s) cubeta(s).

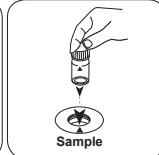

Poner la **cubeta de muestra** en el compartimiento de medición. ¡Debe tenerse en cuenta el posicionamiento!

• • •

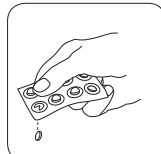

Añadir **tableta ALKA-M-PHOTOMETER**.

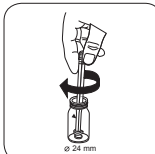

Triturar la(s) tableta(s) girando ligeramente.

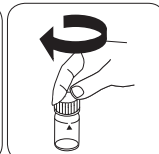

Cerrar la(s) cubeta(s).

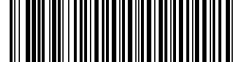

Dióxido de cloro PP

M122

0.04 - 3.8 mg/L ClO₂

CLO2

DPD

ES

Material

Material requerido (parcialmente opcional):

Reactivos	Unidad de embalaje	No. de referencia
Cloro libre DPD F10	Polvos / 100 Cantidad	530100
Cloro libre DPD F10	Polvos / 1000 Cantidad	530103
Glicina ⁹	Tabletas / 100	512170BT
Glicina ⁹	Tabletas / 250	512171BT
Reactivo de glicina VARIO 10 %, 29 ml	29 mL	532210

Muestreo

1. Evitar durante la preparación de la muestra la desgasificación, p. ej., al pipetar o agitar.
2. La determinación se ha de realizar inmediatamente después de la toma de la muestra.

Preparación

1. Limpieza de las cubetas:
Muchos productos de limpieza (p. ej., detergentes de lavavajillas) poseen componentes reductores, que pueden reducir los resultados en la determinación del Dióxido de cloro. Para evitar estas alteraciones, los aparatos de vidrio deben estar exentos de componentes corrosivos al cloro. Para ello, deberá sumergir los aparatos de vidrio durante una hora en una solución de hipoclorito sódico (0,1 g/L), enjuagándolos minuciosamente a continuación con agua desionizada.
2. Las muestras acuosas muy ácidas o muy básicas se deberán neutralizar a un valor de pH entre 6 y 7 antes de realizar el análisis (con 0,5 mol/l de ácido sulfúrico o 1 mol/l de hidróxido sódico).

Ejecución de la determinación Dióxido de cloro con reactivo Powder Pack, en ausencia de cloro

Seleccionar el método en el aparato.

Seleccione además la determinación: en ausencia de cloro

Para este método, no es necesario realizar una medición CERO cada vez en los siguientes dispositivos: XD 7000, XD 7500



Llenar la cubeta de 24 mm con **10 mL de muestra** .

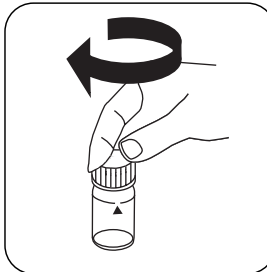

Cerrar la(s) cubeta(s).

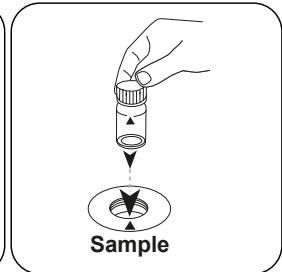

Poner la **cubeta de muestra** en el compartimiento de medición. ¡Debe tenerse en cuenta el posicionamiento!

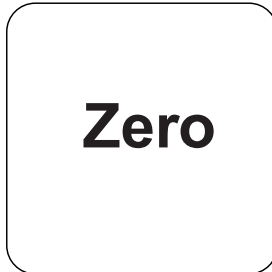

Pulsar la tecla **ZERO**.

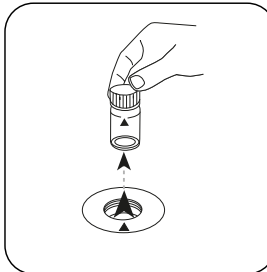

Extraer la cubeta del compartimiento de medición.

Para los aparatos que **no requieran medición CERO** , **empezar aquí**.

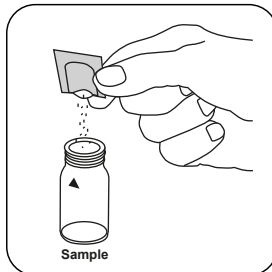

Añadir un **sobre de polvos Chlorine FREE-DPD / F10**

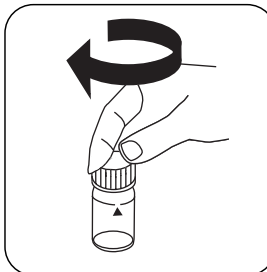

Cerrar la(s) cubeta(s).

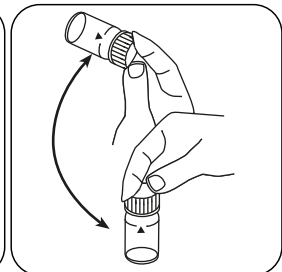

Mezclar el contenido girando (20 sec.).

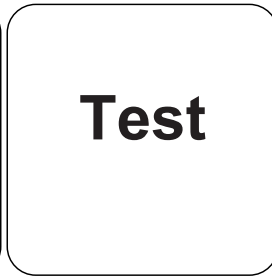
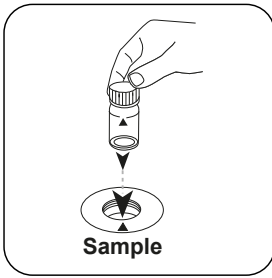

ES

Poner la **cupeta de muestra** en el compartimiento de medición. ¡Debe tenerse en cuenta el posicionamiento!

Pulsar la tecla **TEST** (XD: **START**).

A continuación se visualizará el resultado en mg/L Dióxido de cloro.

Ejecución de la determinación Dióxido de cloro con reactivo Powder Pack, en presencia de cloro

Seleccionar el método en el aparato.

Seleccione además la determinación: junto a cloro

Para este método, no es necesario realizar una medición CERO cada vez en los siguientes dispositivos: XD 7000, XD 7500



Llenar la cupeta de 24 mm con **10 mL de muestra**.

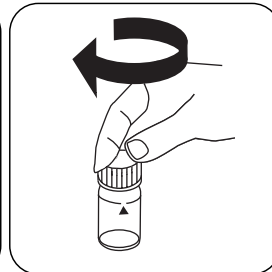

Cerrar la(s) cupeta(s).

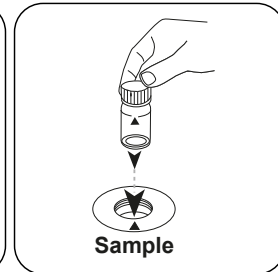

Poner la **cupeta de muestra** en el compartimiento de medición. ¡Debe tenerse en cuenta el posicionamiento!

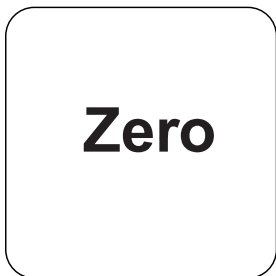

Pulsar la tecla **ZERO**.

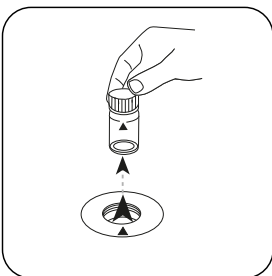

Extraer la cubeta del compartimiento de medición.

Para los aparatos que **no requieran medición CERO**, empezar aquí.

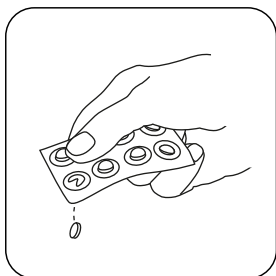

Añadir **tableta GLYCINE**.

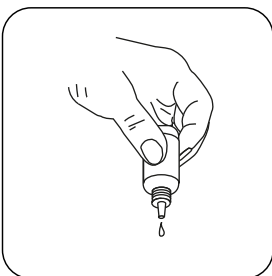

o añadir 4 gotas de GLYCINE Reagent.

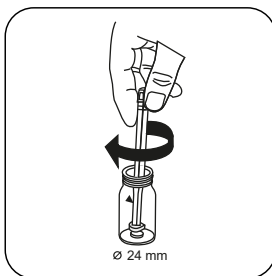

Triturar la(s) tableta(s) girando ligeramente.

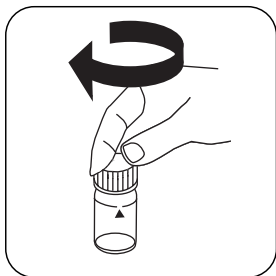

Cerrar la(s) cubeta(s).

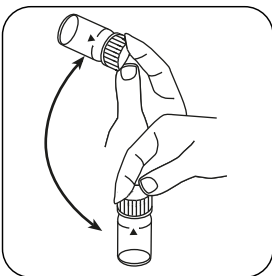

Disolver la(s) tableta(s) girando.

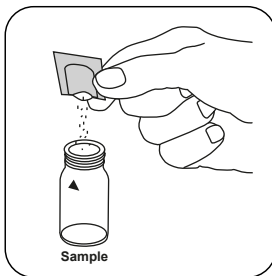

Añadir un sobre de polvos **Chlorine-Free-DPD/ F10**.



ES

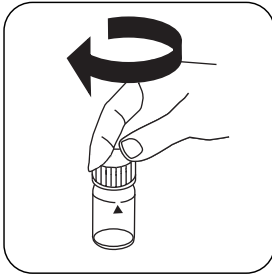

Cerrar la(s) cubeta(s).

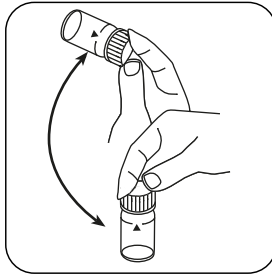

Mezclar el contenido girando (20 sec.).

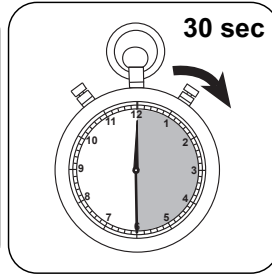

Esperar **30 segundos como periodo de reacción.**

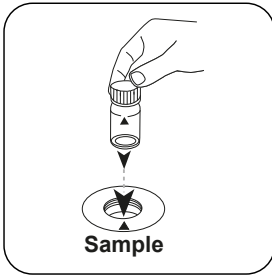

Poner la **cubeta de muestra** en el compartimiento de medición. ¡Debe tenerse en cuenta el posicionamiento!

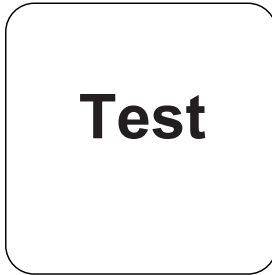

Pulsar la tecla **TEST** (XD: **START**).

A continuación se visualizará el resultado en mg/L Dióxido de cloro.



Método químico

DPD

Apéndice

Interferencia

ES

Interferencias persistentes

1. Todos los elementos oxidantes existentes en la muestra producen un resultado más elevado.

Interferencias extraíbles

1. Las concentraciones de dióxido de cloro mayores a 3,8 mg/L pueden conducir a resultados de dentro del campo de medición hasta 0 mg/L. En este caso, se deberá diluir la muestra acuosa con agua libre de dióxido de cloro. Se mezclan 10 ml de muestra diluida con reactivo y se repite la medición (prueba de plausibilidad).

Derivado de

DIN 38408, parte 5

¹ Reactivo auxiliar, necesario adicionalmente para la determinación de bromo, dióxido de cloro y ozono en presencia de cloro

KS4.3 T / 20



Nom de la méthode → KS4.3 T

Numéro de méthode → 20

Code à barres pour reconnaître la méthode

Plage de mesure → 0.1 - 4 mmol/l $K_{S4.3}$

Méthode chimique → Acide / Indicateur

Affichage dans le MD 100 / MD 110 / MD 200 → S:4.3

Informations spécifiques à l'instrument

Le test peut être effectué sur les appareils suivants. De plus, la cuvette requise et la plage d'absorption du photomètre sont indiquées.

Appareils	Cuvette	λ	Gamme de mesure
MD 200, MD 600, MD 610, MD 640, MultiDirect, PM 620, PM 630	ø 24 mm	610 nm	0.1 - 4 mmol/l $K_{S4.3}$
SpectroDirect, XD 7000, XD 7500	ø 24 mm	615 nm	0.1 - 4 mmol/l $K_{S4.3}$

Matériel

Matériel requis (partiellement optionnel):

Titre	Pack contenant	Code
Alka-M-Photometer	Pastilles / 100	513210BT
Alka-M-Photometer	Pastilles / 250	513211BT

Liste d'applications

- Traitement des eaux usées
- Traitement de l'eau potable
- Traitement de l'eau brute

Indication

1. Les termes Alcalinité-m, Valeur m, Alcalinité totale et Capacité acide $K_{S4.3}$ sont identiques.
2. L'observation exacte du volume d'échantillon de 10 ml est décisive pour l'exactitude du résultat de l'analyse.

Codes de langue ISO 639-1 → FR

État de révision → 01/20

FR Méthodes Manuel 01/20

Procédure du test

Réalisation de la quantification Capacité acide $K_{s4.3}$ avec pastille

Sélectionnez la méthode sur l'appareil.

Cette méthode ne nécessite aucune mesure du zéro sur les appareils suivants : XD 7000, XD 7500

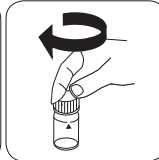
Remplissez une cuvette de 24 mm de **10 ml d'échantillon**.

Fermez la(les) cuvette(s).

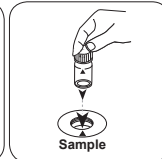
Placez la **cuvette réservée à l'échantillon** dans la chambre de mesure. Attention à la positionner correctement.

• • •

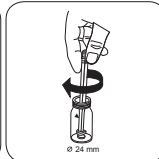
Ajoutez une **pastille de ALKA-M-PHOTOMETER**.

Écrasez la(les) pastille(s) en la(les) tournant un peu.

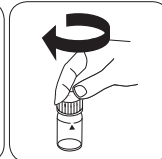

Fermez la(les) cuvette(s).

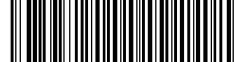

Dioxyde de chlore PP

M122

0.04 - 3.8 mg/L ClO₂

CLO2

DPD

FR

Matériel

Matériel requis (partiellement optionnel):

Réactifs	Pack contenant	Code
Chlore libre DPD F10	Poudre / 100 Pièces	530100
Chlore libre DPD F10	Poudre / 1000 Pièces	530103
Glycine ⁹	Pastilles / 100	512170BT
Glycine ⁹	Pastilles / 250	512171BT
Réactif VARIO Glycine 10 %, 29 ml	29 mL	532210

Échantillonnage

1. Lors de la préparation de l'échantillon, il faudra éviter le dégazage, par ex. par pipetage ou agitation.
2. L'analyse devra avoir lieu immédiatement après le prélèvement de l'échantillon.

Préparation

1. Nettoyage des cuvettes :
Beaucoup de produits de nettoyage domestiques (par ex. liquide vaisselle) contenant des agents réducteurs, il est possible que lors de la quantification du Dioxyde de chlore, les résultats soient plus bas. Pour exclure ces erreurs, les instruments en verre utilisés devraient être insensibles aux effets du chlore. Pour ce faire, il convient de laisser les instruments en verre pendant une heure dans une solution d'hypochlorite de sodium (0,1 g/L) et de bien les rincer ensuite à l'eau déminéralisée (eau entièrement dessalée).
2. Avant l'analyse, les eaux fortement alcalines ou acides devraient être ajustées sur un pH compris entre 6 et 7 (avec 0,5 mol/l d'acide sulfurique ou 1 mol/l de soude caustique).

Réalisation de la quantification Dioxyde de chlore, en l'absence de chlore avec sachets de poudre

Sélectionnez la méthode sur l'appareil.

Sélectionnez également la quantification : sans chlore

Pour cette méthode, il n'est pas nécessaire d'effectuer une mesure ZERO à chaque fois sur les appareils suivants : XD 7000, XD 7500



Remplissez une cuvette de 24 mm de **10 mL d'échantillon**.

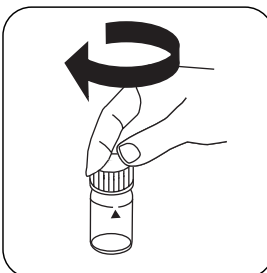

Fermez la(les) cuvette(s).

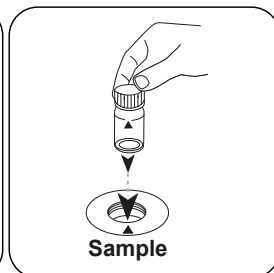

Placez la **cuvette réservée à l'échantillon** dans la chambre de mesure. Attention à la positionner correctement.

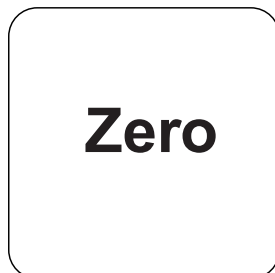

Appuyez sur la touche **ZERO**.

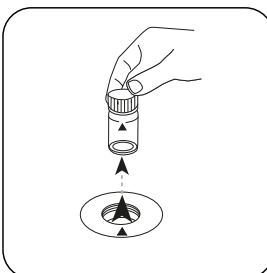

Retirez la cuvette de la chambre de mesure.

Sur les appareils ne nécessitant **aucune mesure ZÉRO**, commencez ici.

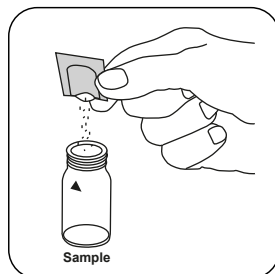

Ajoutez un **sachet de poudre Chlorine FREE-DPD / F10**.

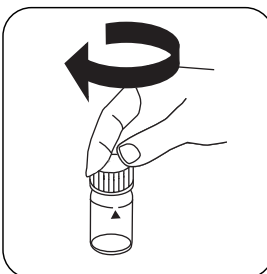

Fermez la(les) cuvette(s).

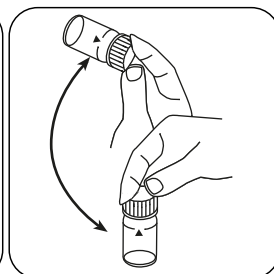

Retourner plusieurs fois pour mélanger le contenu (20 sec.) .

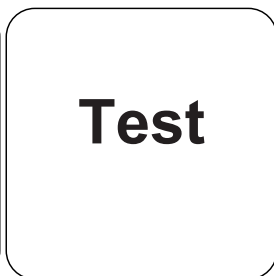
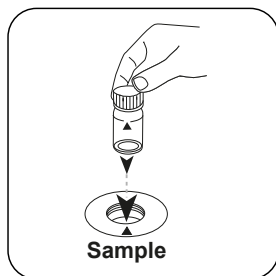

FR

Placez la **cuvette réservée à l'échantillon** dans la chambre de mesure. Attention à la positionner correctement.

Appuyez sur la touche **TEST (XD: START)**.

Le résultat s'affiche à l'écran en mg/L dioxyde de chlore.

Réalisation de la quantification Dioxyde de chlore, en présence de chlore avec sachets de poudre

Sélectionnez la méthode sur l'appareil.

Sélectionnez également la quantification : en présence de chlore

Pour cette méthode, il n'est pas nécessaire d'effectuer une mesure ZERO à chaque fois sur les appareils suivants : XD 7000, XD 7500



Remplissez une cuvette de 24 mm de **10 mL d'échantillon**.

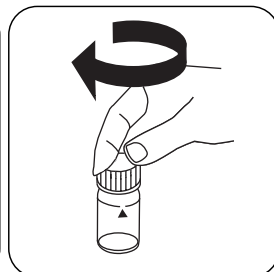

Fermez la(les) cuvette(s).

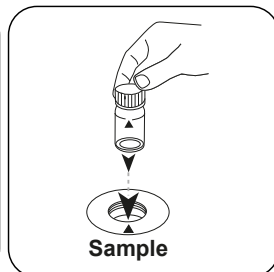

Placez la **cuvette réservée à l'échantillon** dans la chambre de mesure. Attention à la positionner correctement.

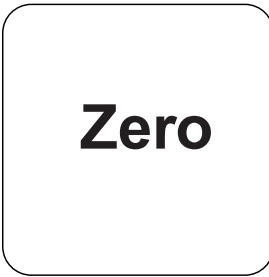

Appuyez sur la touche **ZERO**.

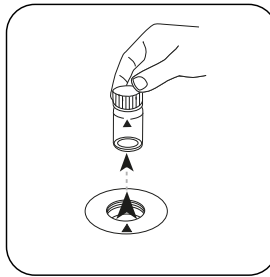

Retirez la cuvette de la chambre de mesure.

Sur les appareils ne nécessitant **aucune mesure ZÉRO**, commencez ici.

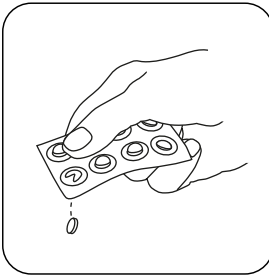

Ajoutez une **pastille de GLYCINE**.

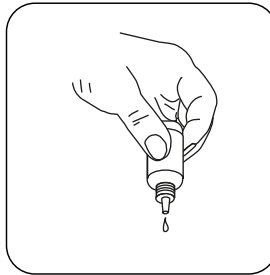

ou ajoutez 4 gouttes de GLYCINE Reagent.

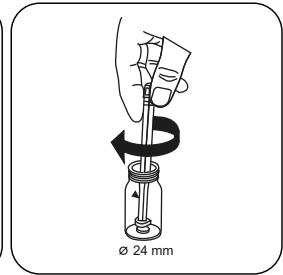

Écrasez la(les) pastille(s) en la(les) tournant un peu.

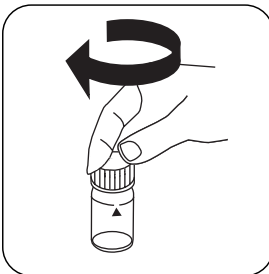

Fermez la(les) cuvette(s).

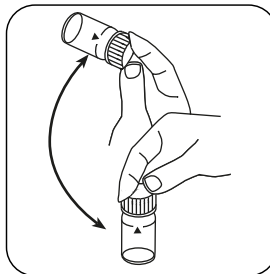

Dissolvez la(les) pastille(s) en mettant le tube plusieurs fois à l'envers.

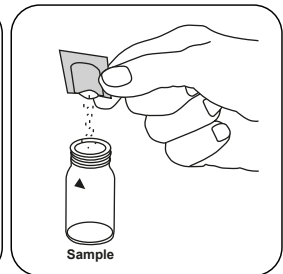

Ajoutez un **sachet de poudre Chlorine-Free-DPD/ F10**.

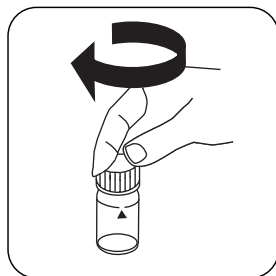

FR Fermez la(les) cuvette(s).

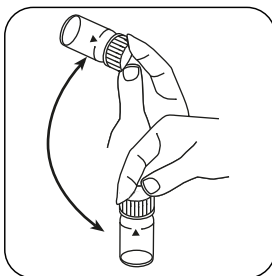

Retourner plusieurs fois pour mélanger le contenu (20 sec.) .

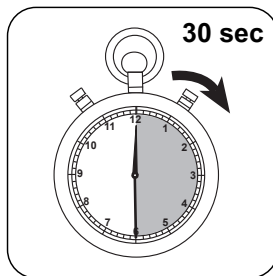

Attendez la fin du **temps de réaction de 30 secondes** .

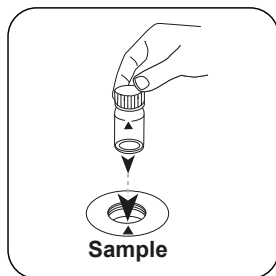

Placez la **cuvette réservée à l'échantillon** dans la chambre de mesure. Attention à la positionner correctement.

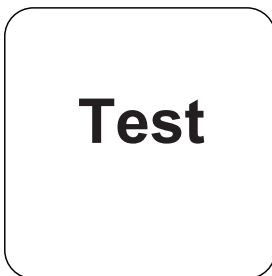

Appuyez sur la touche **TEST (XD: START)**.

Le résultat s'affiche à l'écran en mg/L dioxyde de chlore.



Méthode chimique

DPD

Appendice

Interférences

FR

Interférences persistantes

1. Les agents oxydants contenus dans les échantillons entraînent tous des résultats plus élevés.

Interférences exclues

1. Les concentrations de dioxyde de chlore supérieures à 3,8 mg/L peuvent provoquer des résultats dans la plage de mesure allant jusqu'à 0 mg/L. Dans ce cas, diluez l'échantillon d'eau en utilisant de l'eau exempte de dioxyde de chlore. Le réactif est ajouté à 10 ml d'échantillon dilué. Ensuite, la mesure est répétée (test de plausibilité).

Dérivé de

DIN 38408, 5^e partie

¹nécessaire pour la détermination de brome, dioxyde de chlore et ozone en présence de chlore

KS4.3 T / 20



Nome do método

Número do método

Código de barras para a detecção dos métodos

Área de medição

$K_{S_{4.3}} T$
0.1 - 4 mmol/l $K_{S_{4.3}}$
Ácido / Indicador

20
S:4.3

Indicado no display: MD 100 / MD 110 / MD 200

Método Químico

Informação específica do instrumento

O teste pode ser realizado nos seguintes dispositivos. Além disso, a cubeta necessária e a faixa de absorção do fotómetro são indicadas.

Dispositivos	Cubeta	λ	Faixa de Medição
MD 200, MD 600, MD 610, MD 640, MultiDirect, PM 620, PM 630	ø 24 mm	610 nm	0.1 - 4 mmol/l $K_{S_{4.3}}$
SpectroDirect, XD 7000, XD 7500	ø 24 mm	615 nm	0.1 - 4 mmol/l $K_{S_{4.3}}$

Material

Material necessário (parcialmente opcional):

Título	Unidade de Embalagem	Artigo No
Alka-M-Photometer	Pastilhas / 100	513210BT
Alka-M-Photometer	Pastilhas / 250	513211BT

Lista de Aplicações

- Tratamento de Esgotos
- Tratamento de Água Potável
- Tratamento de Água Bruta

Notas

1. Os termos alcalinidade-m, m-valor, alcalinidade total e capacidade de acidez $K_{S_{4.3}}$ são idênticos.
2. O cumprimento exato do volume da amostra de 10 ml é decisivo para a precisão do resultado de análise.

Códigos de idioma ISO 639-1

Nível de revisão

PT Métodos Manual 01/20

Efetuar a medição

Realização da determinação Capacidade de acidez $K_{s4.3}$ com pastilha

Escolher o método no equipamento.

Para este método não tem de ser efetuada uma medição ZERO nos seguintes equipamentos: XD 7000, XD 7500

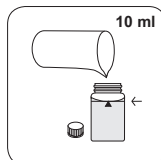

Encher a célula de 24 mm com 10 ml de amostra .

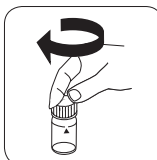

Fechar a(s) célula(s).

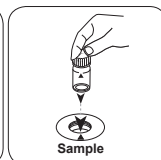

Colocar a **célula de amostra** no compartimento de medição. Observar o posicionamento.

• • •

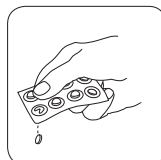

Pastilha ALKA-M-PHOTO-METER.

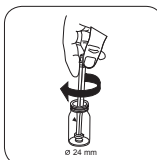

Esmagar a(s) pastilha(s) rodando ligeiramente.

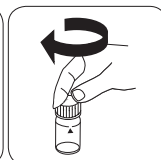

Fechar a(s) célula(s).

PT Métodos Manual 01/20

PT

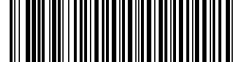

Dióxido de cloro PP

M122

0.04 - 3.8 mg/L ClO₂

CLO2

DPD

PT

Material

Material necessário (parcialmente opcional):

Reagentes	Unidade de Embalagem	Código do Produto
Sem cloro DPD F10	Pó / 100 pc.	530100
Sem cloro DPD F10	Pó / 1000 pc.	530103
Glicina ⁹	Pastilhas / 100	512170BT
Glicina ⁹	Pastilhas / 250	512171BT
VARIO Glycine Reagente 10 %, 29 ml	29 mL	532210

Amostragem

1. Na preparação da amostra é preciso evitar a libertação de gases, p. ex. através da pipetagem e agitação.
2. A análise tem de ser efetuada logo após a recolha da amostra.

Preparação

1. Limpeza das células:
Uma vez que muitos produtos de limpeza domésticos (p. ex. lava-louça) contêm substâncias redutoras, na determinação de Dióxido de cloro pode haver demasiadas reduções. Para excluir este erro de medição, os equipamentos de vidro não deviam ter a capacidade de absorção de cloro. Para esse efeito, os equipamentos de vidro são guardados por uma hora sob solução de hipoclorito de sódio (0,1 g/L) e depois devem ser bem enxaguados com água desmineralizada.
2. As águas fortemente alcalinas ou ácidas devem, antes da análise, ser ajustadas para um valor pH entre 6 e 7 (com 0,5 mol/l de ácido sulfúrico ou 1 mol/l soda cáustica).

Realização da determinação Dióxido de Cloro, na ausência de cloro com pacotes de pó

Escolher o método no equipamento.

Escolha ainda a determinação: sem Cloro

Para este método, uma medição ZERO não precisa ser realizada todas as vezes nos seguintes dispositivos: XD 7000, XD 7500



Encher a célula de 24 mm com **10 mL de amostra**.

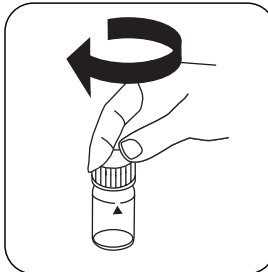

Fechar a(s) célula(s).

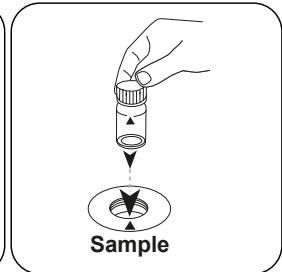

Colocar a **célula de amostra** no compartimento de medição. Observar o posicionamento.

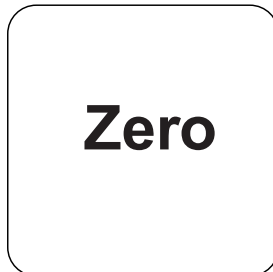

Premir a tecla **ZERO**.

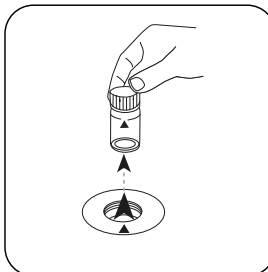

Retirar a célula do compartimento de medição.

Nos equipamentos que **não requerem uma medição ZERO**, deve começar aqui.

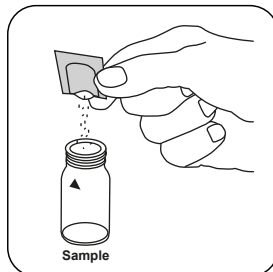

Adicionar um **pacote de pó Chlorine FREE-DPD / F10**

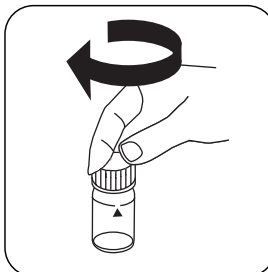

Fechar a(s) célula(s).

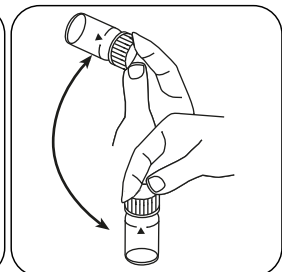

Misturar o conteúdo girando (20 sec.).

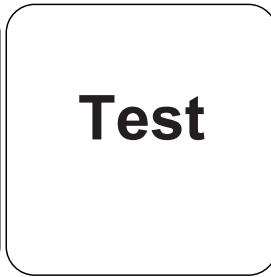
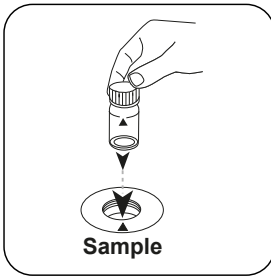

Colocar a **célula de amostra** no compartimento de medição. Observar o posicionamento.

Premir a tecla **TEST** (XD: **START**).

No visor aparece o resultado em mg/L Dióxido de Cloro.

Realização da determinação Dióxido de Cloro, na presença de cloro com pacotes de pó

Escolher o método no equipamento.

Escolha ainda a determinação: na presença de Cloro

Para este método, uma medição ZERO não precisa ser realizada todas as vezes nos seguintes dispositivos: XD 7000, XD 7500



Encher a célula de 24 mm com **10 mL de amostra**.

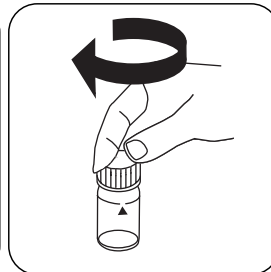

Fechar a(s) célula(s).

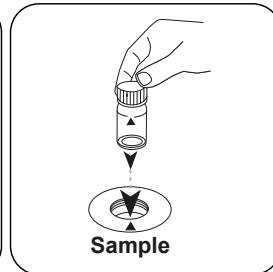

Colocar a **célula de amostra** no compartimento de medição. Observar o posicionamento.

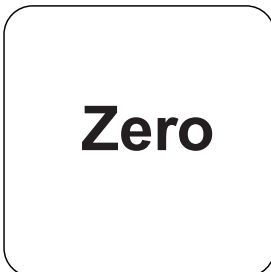

Premir a tecla **ZERO**.

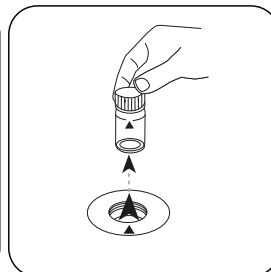

Retirar a célula do compartimento de medição.



Nos equipamentos que **não requerem uma medição ZERO**, deve começar aqui.

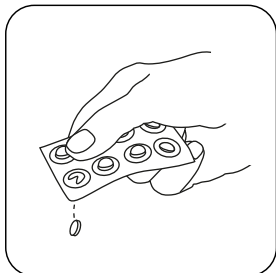

Pastilha GLYCINE.

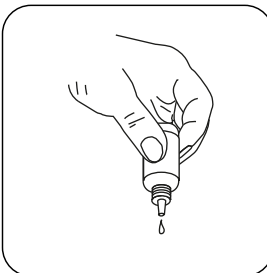

ou adicionar 4 gotas
GLYCINE Reagent.

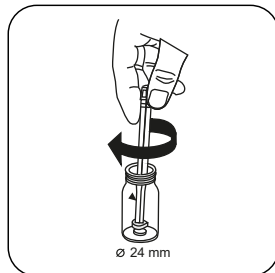

Esmagar a(s) pastilha(s)
rodando ligeiramente.

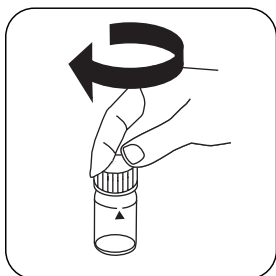

Fechar a(s) célula(s).

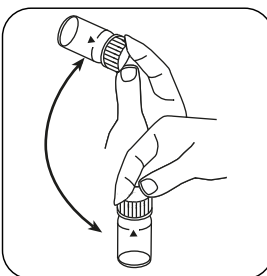

Dissolver a(s) pastilha(s)
girando.

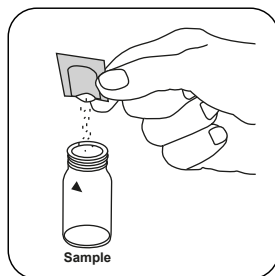

Adicionar um **pacote de pó**
Chlorine-Free-DPD/ F10.

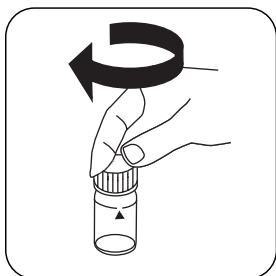

Fechar a(s) célula(s).

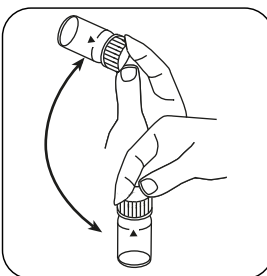

Misturar o conteúdo
girando (20 sec.).

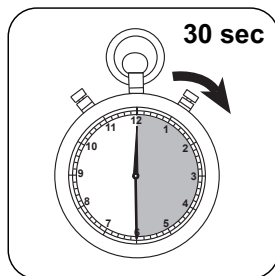

Aguardar **30 segundos de**
tempo de reação.

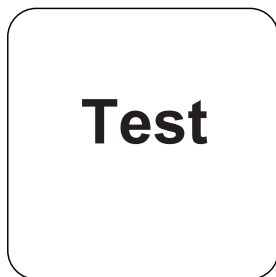

PT

Colocar a **célula de amostra** no compartimento de medição. Observar o posicionamento.

Premir a tecla **TEST** (XD: **START**).

No visor aparece o resultado em mg/L Dióxido de Cloro.



Método Químico

DPD

Apêndice

Texto de Interferências

PT

Interferências Persistentes

1. Todos os oxidantes presentes nas amostras levam a resultados demasiado altos.

Interferências Removíveis

1. Concentrações de dióxido de cloro superiores a 3,8 mg/L podem causar resultados dentro da área de medição até 0 mg/L. Neste caso, deve diluir a amostra de água em água sem dióxido de cloro. 10 ml da amostra diluída é colocada em reagente e a medição é repetida (teste de plausibilidade).

Derivado de

DIN 38408, Parte 5

⁹Reagente auxiliar, é adicionalmente necessário para a determinação de bromo, dióxido de cloro ou ozônio na presença de cloro

KS4.3 T / 20



Denominazione metodo

Numero metodo

Codice a barre per riconoscere il metodo

Range di misura

$K_{S_{4.3}} T$
0.1 - 4 mmol/l $K_{S_{4.3}}$

20
S:4.3

Indicazione sul display del MD 100 / MD 110 / MD 200

Metodo chimico

Acido/indicatore

Informazioni specifiche dello strumento

Il test può essere eseguito sui seguenti dispositivi. Inoltre, sono indicate la cuvetta richiesta e il range di assorbimento del fotometro.

Dispositivi	Cuvetta	λ	Campo di misura
MD 200, MD 600, MD 610, MD 640, MultiDirect, PM 620, PM 630	ø 24 mm	610 nm	0.1 - 4 mmol/l $K_{S_{4.3}}$
SpectroDirect, XD 7000, XD 7500	ø 24 mm	615 nm	0.1 - 4 mmol/l $K_{S_{4.3}}$

Materiale

Materiale richiesto (in parte facoltativo):

Titolo	Unità di imballaggio	N. ordine
Alka-M-Photometer	Pastiglia / 100	513210BT
Alka-M-Photometer	Pastiglia / 250	513211BT

Campo di applicazione

- Trattamento acqua di scarico
- Trattamento acqua potabile
- Trattamento acqua non depurata

Note

1. I termini alcalinità M, valore M, alcalinità totale e capacità acida $K_{S_{4.3}}$ sono equivalenti.
2. Per l'accuratezza del risultato dell'analisi è fondamentale che il volume del campione misuri esattamente 10 ml.

ISO 639-1 codici linguistici

Stato di revisione

IT Manuale dei Metodi 01/20

**Svolgimento della
misurazione**

Esecuzione della rilevazione Capacità acida $K_{s4,3}$ con pastiglia

Selezionare il metodo nel dispositivo.

Con i seguenti dispositivi, per questo metodo non è necessario eseguire una misurazione ZERO: XD 7000, XD 7500



Riempire una cuvetta da 24 mm con **10 ml di campione**.



Chiudere la/e cuvetta/e.

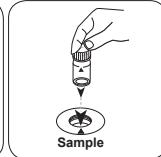

Posizionare la **cuvetta del campione** nel vano di misurazione. Fare attenzione al posizionamento.

• • •

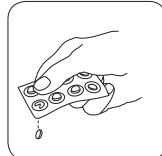

Aggiungere una **pastiglia ALKA-M-PHOTOMETER**.

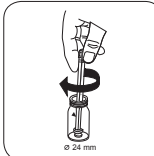

Frantumare la/e pastiglia/e con una leggera rotazione.

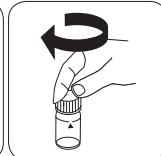

Chiudere la/e cuvetta/e.

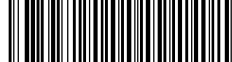

Biossido di cloro PP

M122

0.04 - 3.8 mg/L ClO₂

CLO2

DPD

IT

Materiale

Materiale richiesto (in parte facoltativo):

Reagenti	Unità di imballaggio	N. ordine
Cloro libero DPD F10	Polvere / 100 pz.	530100
Cloro libero DPD F10	Polvere / 1000 pz.	530103
Glicina ⁹	Pastiglia / 100	512170BT
Glicina ⁹	Pastiglia / 250	512171BT
VARIO Glicina Reagente VARIO 10 %, 29 ml	29 mL	532210

Prelievo del campione

1. Nella preparazione del campione occorre evitare la degassificazione, ad es. utilizzando pipette e agitando.
2. L'analisi deve essere eseguita subito dopo il prelievo del campione.

Preparazione

1. Pulizia delle cuvette:
Poiché molti detersivi ad uso domestico (ad es. detersivo per piatti) contengono sostanze riducenti, nella rilevazione del Biossido di cloro si potrebbero ottenere risultati troppo bassi. Per escludere tali errori di misura è necessario che i dispositivi in vetro siano esenti dal consumo di cloro. I dispositivi in vetro inoltre vengono conservati in una soluzione di ipoclorito di sodio (0,1 g/L) per un'ora e successivamente vengono risciacquati abbondantemente con acqua demineralizzata.
2. Le acque fortemente alcaline o acide devono essere portate prima dell'analisi entro un range di pH compreso tra 6 e 7 (con 0,5 mol/l di acido solforico o 1 mol/l di liscivia).

Esecuzione della rilevazione Biossido di cloro, in assenza di cloro con confezioni in polvere

Selezionare il metodo nel dispositivo.

Selezionare inoltre la determinazione: senza Cloro

Per questo metodo, non è necessario eseguire una misurazione ZERO ogni volta sui seguenti dispositivi: XD 7000, XD 7500



Riempire una cuvetta da 24 mm con **10 mL di campione**.

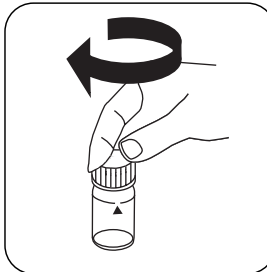

Chiudere la/e cuvetta/e.

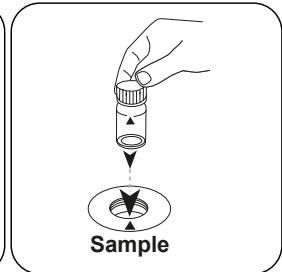

Posizionare la **cuvetta del campione** nel vano di misurazione. Fare attenzione al posizionamento.

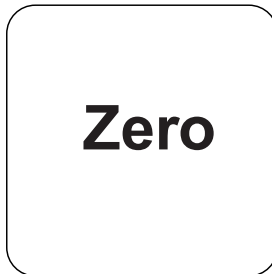

Premere il tasto **ZERO**.

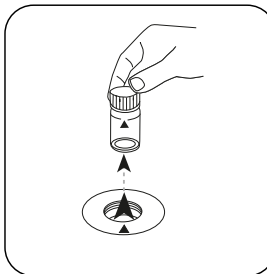

Prelevare la cuvetta dal vano di misurazione.

In caso di dispositivi che **non richiedono una misurazione ZERO**, iniziare da qui.

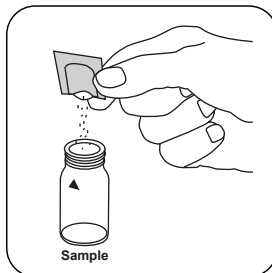

Aggiungere una bustina di polvere **Chlorine FREE-DPD / F10**.

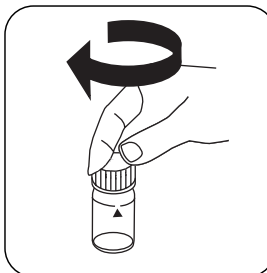

Chiudere la/e cuvetta/e.

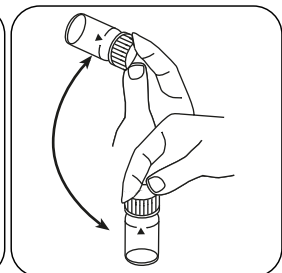

Miscelare il contenuto capovolgendo (20 sec.).

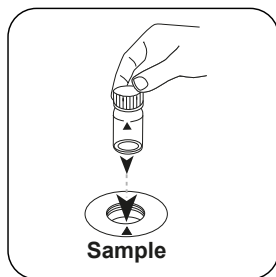

Posizionare la **cuvetta del campione** nel vano di misurazione. Fare attenzione al posizionamento.

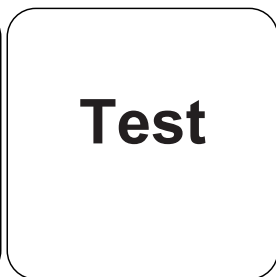

Premere il tasto **TEST (XD: START)**.

Sul display compare il risultato in mg/L di Biossido di cloro.

Esecuzione della rilevazione Biossido di cloro, in presenza di cloro con confezioni in polvere

Selezionare il metodo nel dispositivo.

Selezionare inoltre la determinazione: in presenza di Cloro

Per questo metodo, non è necessario eseguire una misurazione ZERO ogni volta sui seguenti dispositivi: XD 7000, XD 7500



Riempire una cuvetta da 24 mm con **10 mL di campione**.

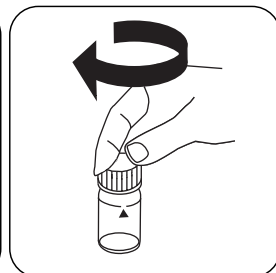

Chiudere la/e cuvetta/e.

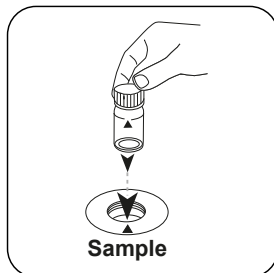

Posizionare la **cuvetta del campione** nel vano di misurazione. Fare attenzione al posizionamento.

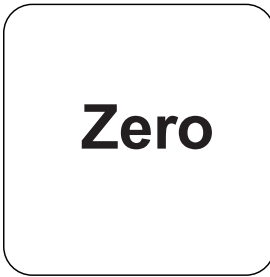

Premere il tasto **ZERO**.

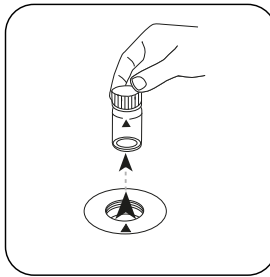

Prelevare la cuvetta dal vano di misurazione.

In caso di dispositivi che **non richiedono una misurazione ZERO**, iniziare da qui.

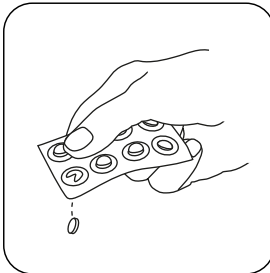

Aggiungere **una pastiglia GLYCINE**.

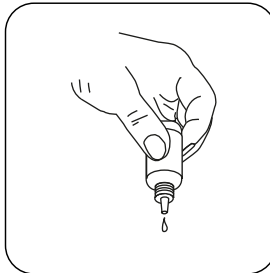

o aggiungere 4 gocce di GLYCINE Reagent.

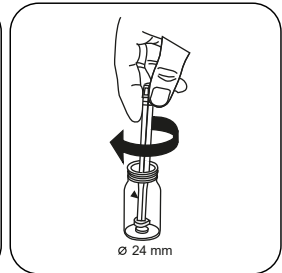

Frantumare la/e pastiglia/e con una leggera rotazione.

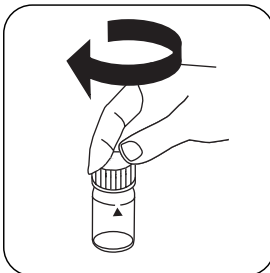

Chiudere la/e cuvetta/e.

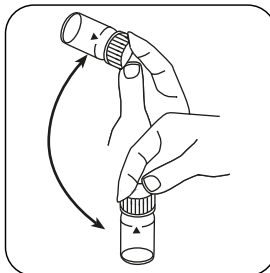

Far sciogliere la/e pastiglia/e agitando.

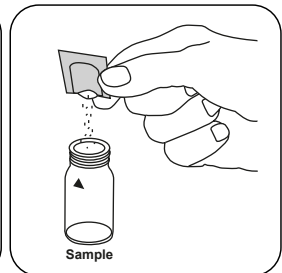

Aggiungere **una bustina di polvere Chlorine-Free-DPD/ F10**.



IT

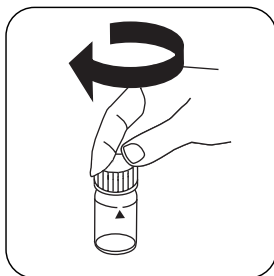

Chiudere la/e cuvetta/e.

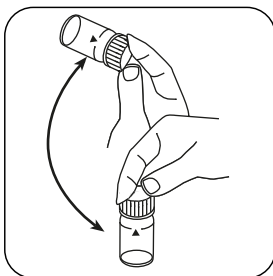

Miscelare il contenuto capovolgendo (20 sec.).

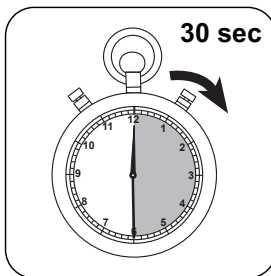

Attendere un **tempo di reazione di 30 secondi**.

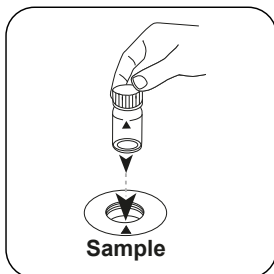

Posizionare la **cuvetta del campione** nel vano di misurazione. Fare attenzione al posizionamento.

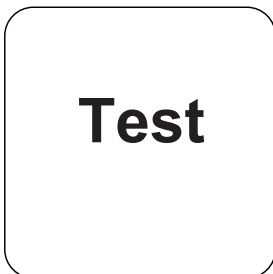

Premere il tasto **TEST** (XD: **START**).

Sul display compare il risultato in mg/L di Biossido di cloro.



Metodo chimico

DPD

Appendice

Interferenze

Interferenze permanenti

1. Tutti gli ossidanti presenti nei campioni danno risultati troppo elevati.

Interferenze escludibili

1. Le concentrazioni di biossido di cloro maggiori di 3,8 mg/L possono dare risultati entro il range di misura fino a 0 mg/L. In questo caso il campione di acqua deve essere diluito con acqua priva di biossido di cloro. 10 ml del campione diluito vengono addizionati con il reagente e la misurazione viene ripetuta (test di plausibilità).

Derivato di

DIN 38408, parte 5

⁹Reagente ausiliario, è inoltre necessario per la determinazione di bromo, biossido di cloro o ozono in presenza di cloro

KS4.3 T / 20



Naam van de methode

Nummer methode

Streepjescode ter identificatie van de methode

Meetbereik

$K_{S_{4.3}} T$ M20
0.1 - 4 mmol/l $K_{S_{4.3}}$ S:4.3
Zuur / Indicator

Chemische methode

Uitlezing in MD
100 MD 110 / MD 200

Instrument specifieke informatie

De test kan op de volgende apparaten worden uitgevoerd. Bovendien worden de vereiste cuvette en het absorptiebereik van de fotometer aangegeven.

Toestellen	Cuvet	λ	Meetbereik
MD 200, MD 600, MD 610, MD 640, MultiDirect, PM 620, PM 630	\varnothing 24 mm	610 nm	0.1 - 4 mmol/l $K_{S_{4.3}}$
SpectroDirect, XD 7000, XD 7500	\varnothing 24 mm	615 nm	0.1 - 4 mmol/l $K_{S_{4.3}}$

Reagentia

Benodigd materiaal (deels optioneel):

Titel	Verpakkingseenheid	Bestelnr.
Alka-M-Photometer	Tablet / 100	513210BT
Alka-M-Photometer	Tablet / 250	513211BT

Toepassingsbereik

- Afvalwaterzuivering
- Behandeling drinkwater
- Zuivering vervuild water

Aantekeningen

1. De termen alkaliteit-m, m-waarde, totale alkaliteit en zuurcapaciteit_{S_{4.3}} zijn identiek.
2. De exacte naleving van het monstervolume van 10 ml is bepalend voor de nauwkeurigheid van het analysesresultaat.

Beknopte naam conform de norm ISO 639-1

Herziene versie

NL Handboek van Methoden 01/20

Uitvoering van de meting

Uitvoering van de bepaling Zuurcapaciteit $K_{s4,3}$ met tablet

De methode in het apparaat selecteren.

Voor deze methode moet bij de volgende apparaten geen nulmeting worden uitgevoerd:
XD 7000, XD 7500



Spoelbakje van 24 mm met **10 ml staal** vullen.

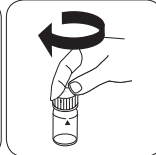

De spoelbakjes afsluiten.

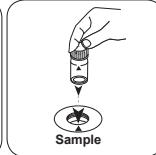

Het **staalspoelbakje** in de meetschacht plaatsen. Op de positionering letten.

• • •

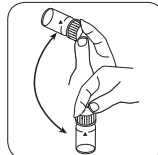

Tabletten oplossen door om te draaien

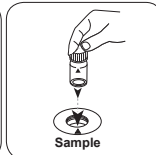

Het **staalspoelbakje** in de meetschacht plaatsen. Op de positionering letten.



De toets **TEST (XD: START)** indrukken.

De display toont het resultaat als Zuurcapaciteit $K_{s4,3}$.

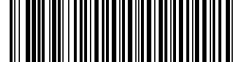

Chloordioxide PP

M122

0.04 - 3.8 mg/L ClO₂

CLO2

DPD

NL

Reagentia

Benodigd materiaal (deels optioneel):

Reagentia	Verpakkingseenheid	Bestelnr.
Chloor vrij DPD F10	Poeder / 100 St.	530100
Chloor vrij DPD F10	Poeder / 1000 St.	530103
Glycine ⁹⁾	Tablet / 100	512170BT
Glycine ⁹⁾	Tablet / 250	512171BT
VARIO Glycine Reagens 10 %, 29 ml	29 mL	532210

Bemonstering

1. Tijdens de monstervoorbereiding moet worden vermeden dat wordt uitgestoten, bijvoorbeeld door pipetteren en schudden.
2. De analyse moet onmiddellijk na de bemonstering worden uitgevoerd.

Vorbereiding

1. Het schoonmaken van de spoelbakjes:
Aangezien veel huishoudelijke reinigingsmiddelen (bijv. afwasmiddelen) minder schadelijke stoffen bevatten, kan de bepaling van Chloordioxide leiden tot minder goede resultaten. Om deze meefout uit te sluiten, moeten de glasapparaten chloorvrij zijn. Hiertoe wordt het glaswerk gedurende één uur onder natriumhypochlorietoplossing (0,1 g/L) bewaard en vervolgens grondig gespoeld met gedeïoniseerd water.
2. Sterk alkalisch of zuur water moet vóór de analyse in een pH-gebied tussen 6 en 7 (met 0,5 mol/l zwavelzuur of 1 mol/l-natriumhydroxideoplossing) worden gebracht.

Uitvoering van de bepaling Chloordioxide, in afwezigheid van chloor, met poederpakjes

De methode in het apparaat selecteren.

Selecteer bovendien de bepaling: zonder chloor

Voor deze methode hoeft niet elke keer een nulmeting uitgevoerd te worden op de volgende apparaten: XD 7000, XD 7500



Spoelbakje van 24 mm met **10 mL staal** vullen.

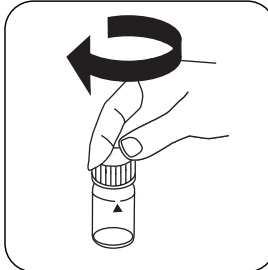

De spoelbakjes afsluiten.

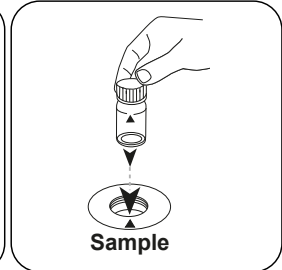

Het **staalspoelbakje** in de meetschacht plaatsen. Op de positionering letten.

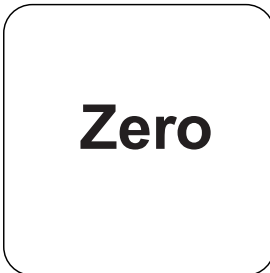

De toets **NUL** indrukken.

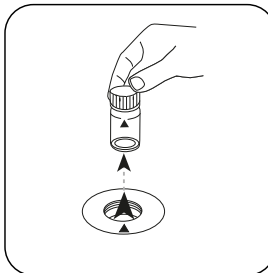

Het spoelbakje uit de meetschacht nemen.

Bij apparaten die **geen nulmeting** vereisen, **hier beginnen**.

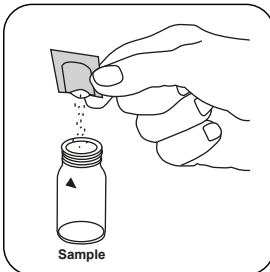

Een **Chloor FREE-DPD / F10 poederpakje** toevoegen.

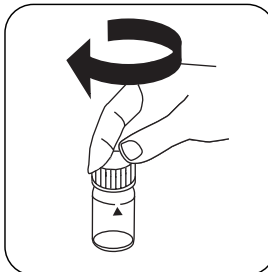

De spoelbakjes afsluiten.

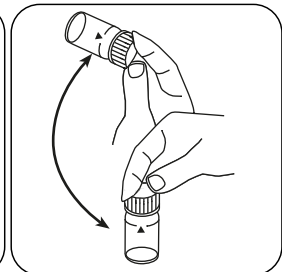

De inhoud mengen door om te draaien (20 sec.).

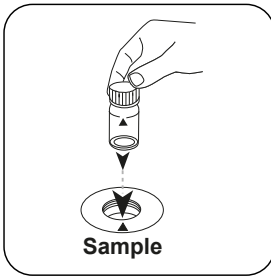

Test

Het **staalspoelbakje** in de meetschacht plaatsen. Op de positionering letten.

De toets **TEST** (XD: **START**) indrukken.

De display toont het resultaat in mg/L Chloordioxide.

Uitvoering van de bepaling Chloordioxide, in afwezigheid van chloor, met poederpakjes

De methode in het apparaat selecteren.

Selecteer bovendien de bepaling: naast chloor

Voor deze methode hoeft niet elke keer een nulmeting uitgevoerd te worden op de volgende apparaten: XD 7000, XD 7500



Spoelbakje van 24 mm met **10 mL** staal vullen.

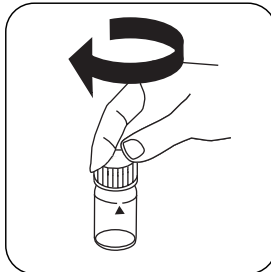

De spoelbakjes afsluiten.

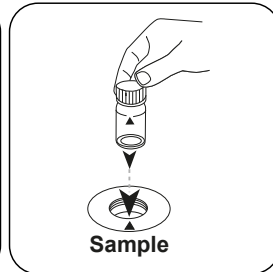

Het **staalspoelbakje** in de meetschacht plaatsen. Op de positionering letten.

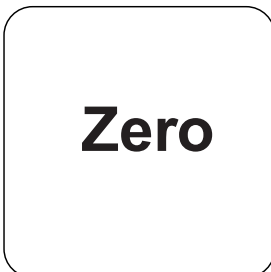

De toets **NUL** indrukken.

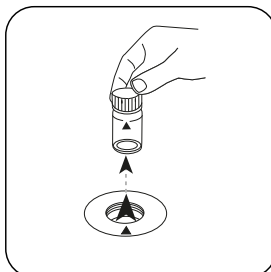

Het spoelbakje uit de meetschacht nemen.

Bij apparaten die **geen nulmeting** vereisen, **hier beginnen**.

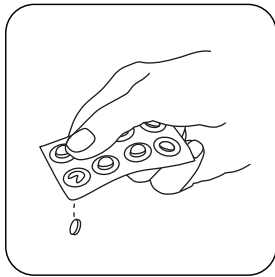

Een **GLYCINE** tablet toevoegen.

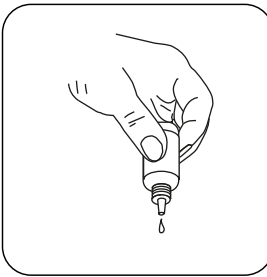

of 4 druppels **GLYCINE** Reagent toevoegen.

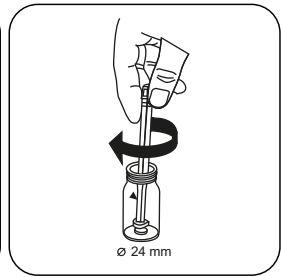

De tabletten onder lichte rotatie verpletteren.

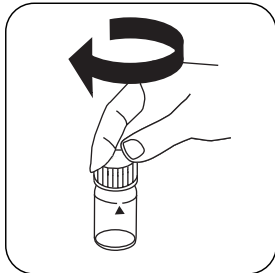

De spoelbakjes afsluiten.

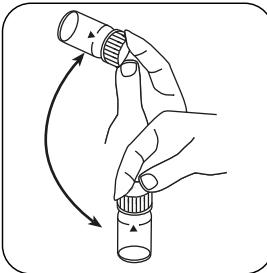

Tabletten oplossen door om te draaien

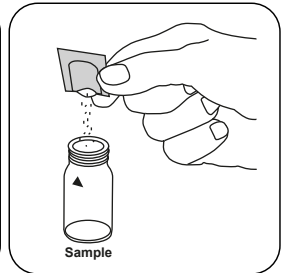

Een **Chloorvrij DPD/ F10 poederpakje** toevoegen.

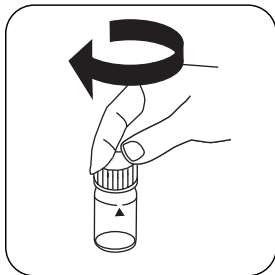

De spoelbakjes afsluiten.

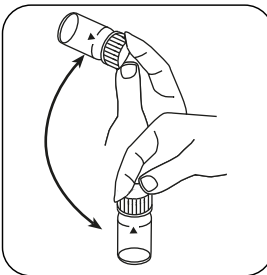

De inhoud mengen door om te draaien (20 sec.).

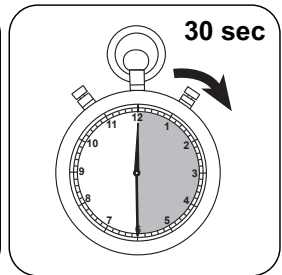

De reactietijd van **30 seconden** afwachten.

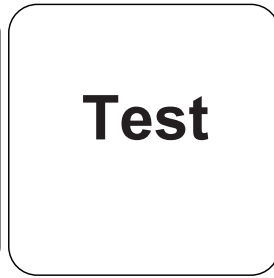
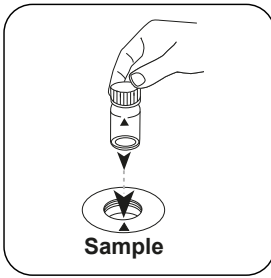

NL

Het **staalpoelbakje** in de meetschacht plaatsen. Op de positionering letten.

De toets **TEST** (XD: **START**) indrukken.

De display toont het resultaat in mg/L Chloordioxide.



Chemische methode

DPD

Aanhangsel

Verstoringen

Permanente verstoringen

1. Alle oxidatiemiddelen in de monsters leiden tot meerdere resultaten.

Uit te sluiten verstoringen

1. Concentraties boven de 3,8 mg/L chloordioxide kan leiden tot resultaten binnen het meetbereik tot 0 mg/L. In dit geval wordt het watermonster verdund met chloordioxidevrij water. Voeg reagens toe aan 10 ml van het verdunde monster en herhaal de meting (plausibiliteitstest).

Afgeleid van

DIN 38408, deel 5

⁹ hulpreagens, extra nodig voor de bepaling van broom, chloordioxide of ozon in aanwezigheid van chloor

NL

KS4.3 T / 20

Yöntem Adı

Yöntemleri numarası

Yöntemi tanımak için barkod

Ölçüm aralığı

Kimyasal Metod

$K_{S4.3} T$
0.1 - 4 mmol/l $K_{S4.3}$
Asit / Gösterge

20
S:4.3

Ekrandaki: MD 100 MD 110 / MD 200

Enstrümana özel bilgi

Test, aşağıdaki cihazlarda gerçekleştirilebilir. Ek olarak, gerekli küvet ve fotometrenin emilim aralığı belirtilmiştir.

Cihazlar	Küvet	λ	Ölçüm Aralığı
MD 200, MD 600, MD 610, MD 640, MultiDirect, PM 620, PM 630	ø 24 mm	610 nm	0.1 - 4 mmol/l $K_{S4.3}$
SpectroDirect, XD 7000, XD 7500	ø 24 mm	615 nm	0.1 - 4 mmol/l $K_{S4.3}$

Malzeme

Gerekli materyal (kısmen isteğe bağlı):

Başlık	Paketleme Birimi	Ürün No
Alka-M-Photometer	Tablet / 100	513210BT
Alka-M-Photometer	Tablet / 250	513211BT

Uygulama Listesi

- Atık Su Arıtma
- İçme Suyu Arıtma
- Ham Su Arıtma

Notlar

1. Alkalite-m, m değeri, toplam alkalite ve asit kapasitesi $K_{S4.3}$ kavramları ayrıdır.
2. 10 ml'lik numune hacmine tam riayet edilmesi, analiz sonucunun doğruluğu bakımından önemlidir.

Dil kodları ISO 639-1

Revizyon durumu

TR Metotlar Kılavuzu 01/20

Testin uygulanması
Tespitin uygulanması Tabletli asit kapasitesi $K_{S4,3}$

Cihazda metot seçin.

Bu metot için şu cihazlarda ZERO ölçümü yapılması gerekmez: XD 7000, XD 7500



24 mm'lik küveti **10 ml numune** ile doldurun.



Küveti(küvetleri) kapatın.

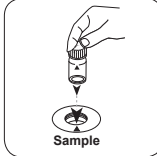

Numune küvetini ölçüm haznesine koyun. Doğru konumlandırılmasına dikkat edin.

• • •

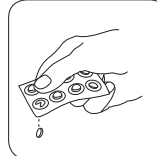

ALKA-M-PHOTOMETER tablet ilave edin.

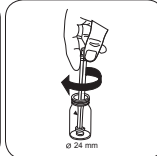

Tableti(tabletleri) hafifçe döndürerek ezin.



Küveti(küvetleri) kapatın.



Klordioksit PP

M122

0.04 - 3.8 mg/L ClO₂

CLO2

DPD

Malzeme

Gerekli materyal (kısmen isteğe bağlı):

Ayırçalar	Paketleme Birimi	Ürün No
Serbest klor DPD F10	Toz / 100 adetler	530100
Serbest klor DPD F10	Toz / 1000 adetler	530103
Glycine ⁹	Tablet / 100	512170BT
Glycine ⁹	Tablet / 250	512171BT
VARIO Glisin Reaktif% 10, 29 ml	29 mL	532210

Numune Alma

1. Numune ön hazırlığı esnasında ör. pipetleme ve çalkalama ile gazlaşması önlenmelidir.
2. Analiz numune alımından hemen sonra yapılmalıdır.

Hazırlık

1. Küvetlerin temizlenmesi:
Birçok ev tipi temizleyici (ör. bulaşık deterjanı) azaltıcı maddeler içerdiğinden klordioksit tespitinde ehemmiyetsiz miktarda bulgulara ulaşılabilir. Bu ölçüm hatasına ihtimal vermemek için cam aletler klordan etkilenmeyecek şekilde olmalıdır. Bunun için cam aletler bir saatliğine sodyum hipoklorit çözeltisinde (0,1 g / L) muhafaza edilir ve sonrasında demineralize su ile iyice yıkanır.
2. Analizden önce aşırı alkali veya asitli suların pH değeri 6 ile 7 arasına getirilmelidir (0,5 mol/l sülfürik asit veya 1 mol/l sodyum hidroksit su ile çözünmüş hali ile).

Tespitin uygulanması Klor dioksit, toz poşetleriyle birlikte klor mevcut değilken

Cihazda metot seçin.

Buna ek olarak tespiti seçin: klor olmadan

Bu yöntem için, aşağıdaki cihazlarda her seferinde SIFIR ölçümünün yapılması gerekmez: XD 7000, XD 7500



24 mm'lik küveti **10 mL numune** ile doldurun.

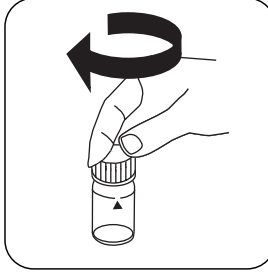

Küveti(küvetleri) kapatın.

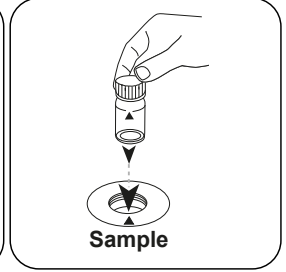

Numune küvetini ölçüm haznesine koyun. Doğru konumlandırılmasına dikkat edin.

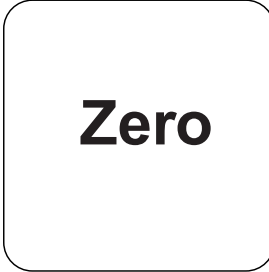

ZERO tuşuna basın.

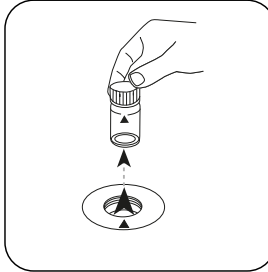

Küveti ölçüm haznesinden alın.

ZERO ölçümü gerektirmeyen cihazlarda buradan başlayın.

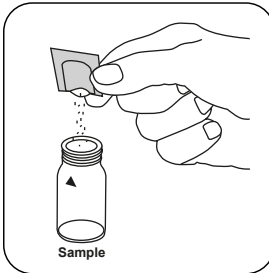

Chlorine FREE-DPD / F10 toz paketi ilave edin.

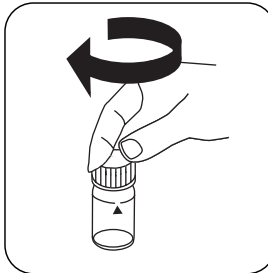

Küveti(küvetleri) kapatın.

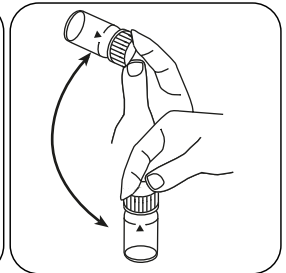

Sallayarak içeriği karıştırın (20 sec.).

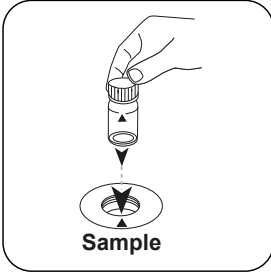

Test

Numune küvetini ölçüm haznesine koyun. Doğru konumlandırılmasına dikkat edin.

TEST (XD: START) tuşuna basın.

Ekranda sonuç mg/L Klor dioksit cinsinden belirir.

Tespitin uygulanması Klor dioksit, toz poşetleriyle birlikte klor mevcutken

Cihazda metot seçin.

Buna ek olarak tespiti seçin: klor mevcutken

Bu yöntem için, aşağıdaki cihazlarda her seferinde SIFIR ölçümünün yapılması gerekmez: XD 7000, XD 7500



24 mm'lik küveti **10 mL numune** ile doldurun.

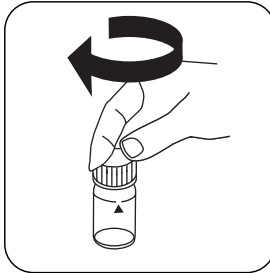

Küveti(küvetleri) kapatın.

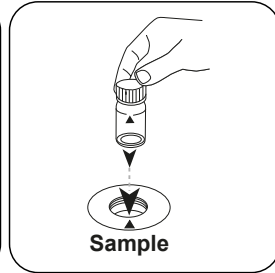

Numune küvetini ölçüm haznesine koyun. Doğru konumlandırılmasına dikkat edin.

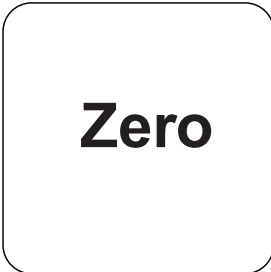

ZERO tuşuna basın.

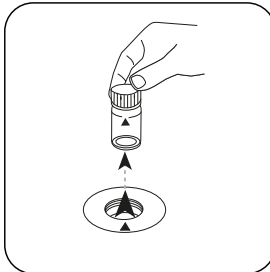

Küveti ölçüm haznesinden alın.



ZERO ölçümü gerektirmeyen cihazlarda buradan başlayın.

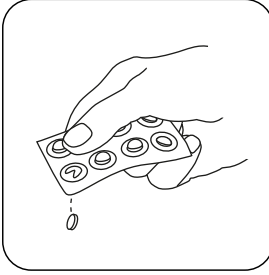

GLYCINE tablet ilave edin.

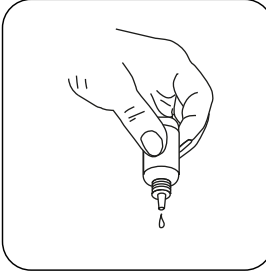

veya 4 damla **GLYCINE Reagent** ilave edin.

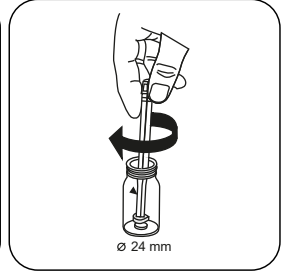

Tableti(tabletleri) hafifçe döndürerek ezin.

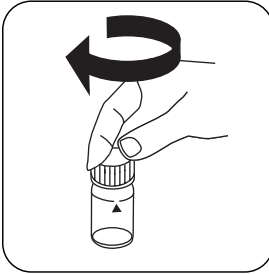

Küveti(küvetleri) kapatın.

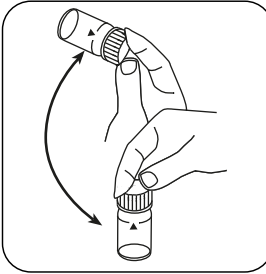

Tableti(tabletleri) sallayarak çözdürün.

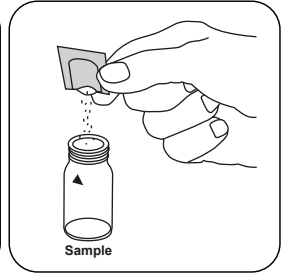

Chlorine-Free-DPD/ F10 toz paketi ilave edin.

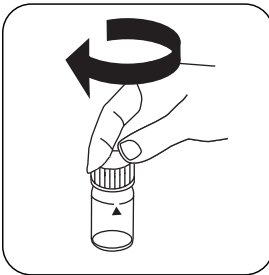

Küveti(küvetleri) kapatın.

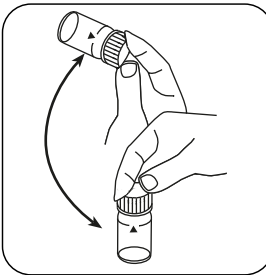

Sallayarak içeriği karıştırın (20 sec.).

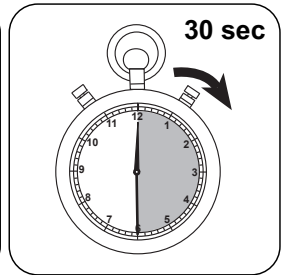

30 saniye tepkime süresi bekleyin.

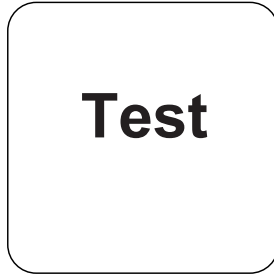
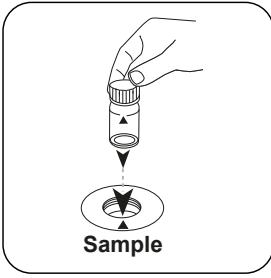

TR

Numune küvetini ölçüm haznesine koyun. Doğru konumlandırılmasına dikkat edin.

TEST (XD: START) tuşuna basın.

Ekranda sonuç mg/L Klor dioksit cinsinden belirir.

Kimyasal Metod

DPD

Aparandis

Girişim Metni

TR

Kalıcı Girişimler

1. Numunelerde bulunan tüm oksidasyon malzemeleri fazla miktarda bulgulara sebep olur.

Giderilebilir Girişimler

1. 3,8 mg/L klordioksit üstünde olan konsantrasyonlar ölçüm aralığının içinde 0 mg/L'ye varan sonuçlara sebep olabilir. Bu durumda su numunesi klordioksit içermeyen su ile seyreltilmelidir. Seyreltilen numunenin 10 ml'sine ayıraç katılır ve ölçüm tekrarlanır (uygunluk testi).

Elde edilen

DIN 38408, kısım 5

* klorun mevcut olması durumunda bromür, klor dioksit ve ozonu belirlemek için gerekir

KS4.3 T / 20



Название метода → KS4.3 T

Номер метода → M20

Штрих-код для распознавания метода → [Barcode]

Диапазон измерений → 0.1 - 4 mmol/l $K_{S4.3}$

Химический метод → Кислота / индикатор

Отображение на дисплее в MD 100 MD 110 / MD 200 → S:4.3

Специфическая информация об инструменте

Тест может быть выполнен на следующих устройствах. Кроме того, указывается требуемая кювета и диапазон поглощения фотометра.

Приборы	Кювета	λ	Диапазон измерений
MD 200, MD 600, MD 610, MD 640, MultiDirect, PM 620, PM 630	\varnothing 24 mm	610 nm	0.1 - 4 mmol/l $K_{S4.3}$
SpectroDirect, XD 7000, XD 7500	\varnothing 24 mm	615 nm	0.1 - 4 mmol/l $K_{S4.3}$

Материал

Необходимый материал (частично необязательный):

Заголовок	Упаковочная единица	Номер заказа
Alka-M-Photometer	Таблетка / 100	513210BT
Alka-M-Photometer	Таблетка / 250	513211BT

Область применения

- Обработка сточных вод
- Подготовка питьевой воды
- Обработка сырой воды

Примечания

1. Термины Щелочность M, m-значение, общая калийность и кислотная сила $K_{S4.3}$ идентичны.
2. Точное соблюдение объема пробы в 10 мл имеет решающее значение для точности результатов анализа.

Сокращенное обозначение языка в соответствии с ISO 639-1 → RU

Статус редакции → 01/20

RU Методическое руководство 01/20

**Выполнение
измерения**
Выполнение определения Кислотная сила $K_{s4.3}$ с таблеткой

Выберите метод в устройстве.

Для этого метода измерения нуля не требуется для следующих устройств: XD 7000, XD 7500



24-Наполните ковеву -мм
10 пробой мл.



Закройте ковеву(ы).

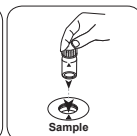

Поместите ковеву для
проб в измерительную
шахту. Обращайте
внимание на
позиционирование.

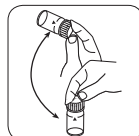

Растворите таблетку
(таблетки) покачиванием.

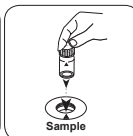

Поместите ковеву для
проб в измерительную
шахту. Обращайте
внимание на
позиционирование.



Нажмите клавишу TEST
(XD: CTAPT).

На дисплее отображается результат в виде Кислотная сила $K_{s4.3}$.

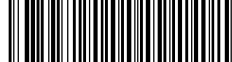

Диоксид хлора PP

M122

0.04 - 3.8 mg/L ClO₂

CLO2

DPD

RU

Материал

Необходимый материал (частично необязательный):

Реактивы	Упаковочная единица	Номер заказа
хлорины свободный DPD F10	Порошок / 100 Шт.	530100
хлорины свободный DPD F10	Порошок / 1000 Шт.	530103
Глицин ⁰	Таблетка / 100	512170BT
Глицин ⁰	Таблетка / 250	512171BT
VARIO глициновый реагент 10%, 29 мл	29 mL	532210

Отбор проб

1. Во время подготовки пробы необходимо избегать выделения, например, из-за пипетирования и встряхивания.
2. Анализ должен проводиться сразу же после отбора проб.

Подготовка

1. Чистка кювет:
Поскольку многие бытовые чистящие средства (например, средства для мытья посуды) содержат восстановительные вещества, при определении Диоксид хлора возможно получение пониженных результатов. Чтобы исключить эту погрешность измерения, стеклянные приборы не должны потреблять хлор. Для этого стеклотара хранится в течение часа под раствором гипохлорита натрия (0,1 г/л), а затем тщательно промывается полностью деминерализованной водой (полностью обессоленной водой).
2. Сильно щелочные или кислые воды должны быть приведены в диапазон pH от 6 до 7 (с 0,5 моль/л серной кислоты или 1 моль/л раствора гидроксида натрия) перед анализом.

Выполнение определения Диоксид хлора в отсутствие хлора, с использованием порошкообразного реагентах

Выберите метод в устройстве.

Также выберите определение: без хлора.

Для этого метода обязательно проводить измерение НУЛЯ каждый раз на следующих устройствах: XD 7000, XD 7500



24-Наполните кювету -мм
10 пробой мл.

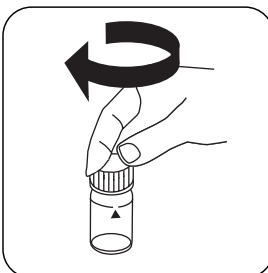

Закройте кювету(ы).

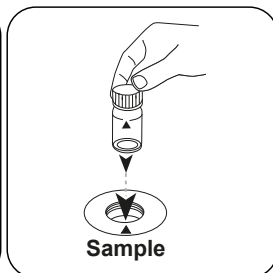

Поместите **кювету для проб** в измерительную шахту. Обращайте внимание на позиционирование.

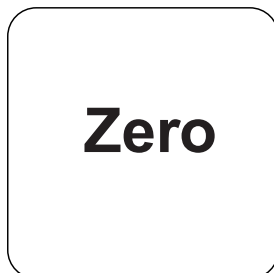

Нажмите клавишу **НОЛЬ** . Извлеките кювету из измерительной шахты.

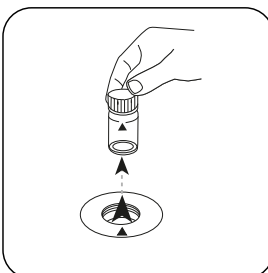

Для приборов, для которых не требуется **измерение нулевого значения** , начните **отсюда**.

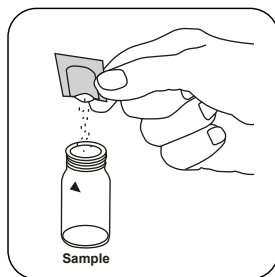

Добавьте **упаковку порошка Chlorine FREE-DPD / F10**.

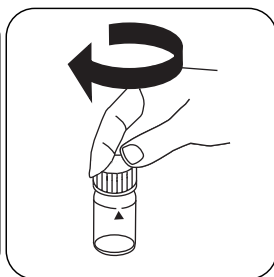

Закройте кювету(ы).

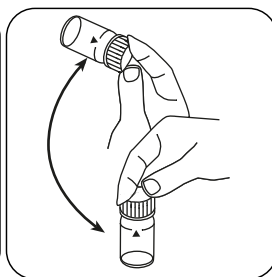

Перемешайте содержимое покачиванием (20 сек.).

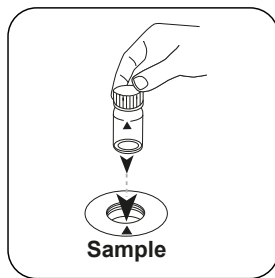

Поместите **кювету для проб** в измерительную шахту. Обращайте внимание на позиционирование.

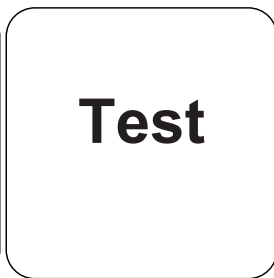

Нажмите клавишу **ТЕСТ** (XD: **СТАРТ**).

На дисплее отображается результат в мг/л Диоксид хлора.

Выполнение определения Диоксид хлора в присутствии хлора, с использованием порошкообразного реагентах

Выберите метод в устройстве.

Также выберите определение: в присутствии хлора.

Для этого метода необязательно проводить измерение НУЛЯ каждый раз на следующих устройствах: XD 7000, XD 7500

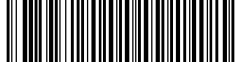

24-Наполните кювету -мм 10 пробой мл.

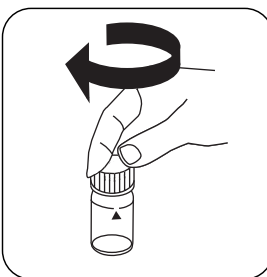

Закройте кювету(ы).

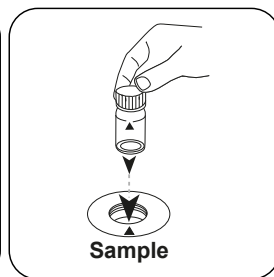

Поместите **кювету для проб** в измерительную шахту. Обращайте внимание на позиционирование.

RU

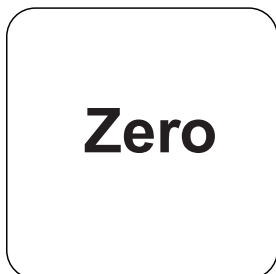

Нажмите клавишу **НОЛЬ**.

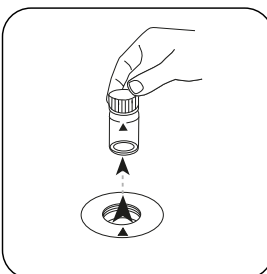

Извлеките кювету из измерительной шахты.

Для приборов, для которых не требуется **измерение нулевого значения**, начните **отсюда**.

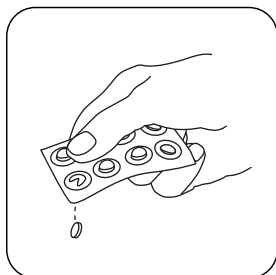

Добавить **таблетку GLYCINE**.

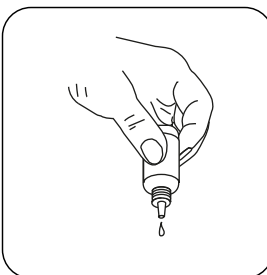

или Добавьте 4 капли GLYCINE Reagent.

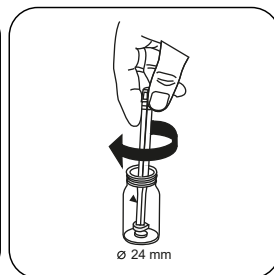

Раздавите таблетку (таблетки) легким вращением.



RU

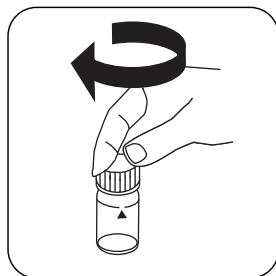

Закройте кювету(ы).

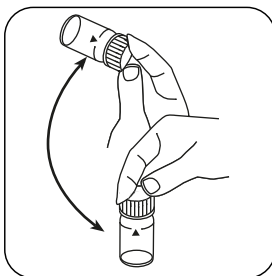

Растворите таблетку (таблетки) покачиванием.

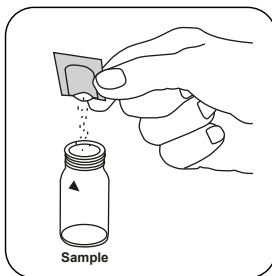

Добавьте **упаковку порошка Chlorine-Free-PPD/ F10.**

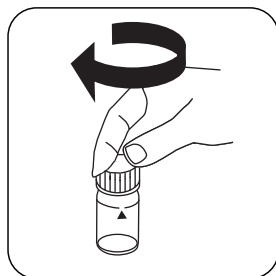

Закройте кювету(ы).

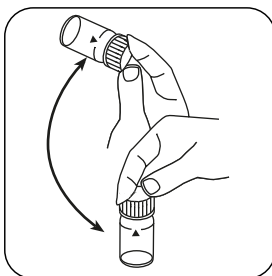

Перемешайте содержимое покачиванием (20 sec.).

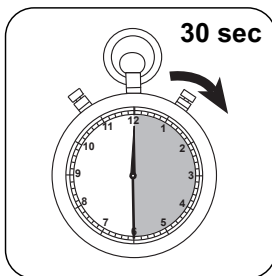

Выдержите **30 время реакции в секундах.**

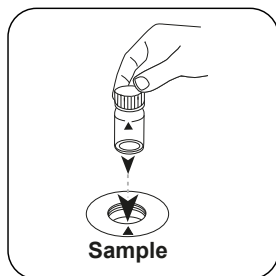

Поместите **кювету для проб** в измерительную шахту. Обращайте внимание на позиционирование.

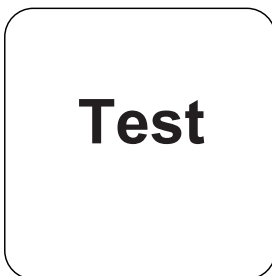

Нажмите клавишу **ТЕСТ** (XD: **СТАРТ**).

На дисплее отображается результат в мг/л Диоксид хлора.



Химический метод

DPD

Приложение

Нарушения

Постоянные нарушения

1. Все оксидационные средства, присутствующие в пробах, дают повышенные результаты.

Исключаемые нарушения

1. Концентрации диоксида хлора свыше 3,8 мг/л могут привести к результатам в диапазоне измерения до 0 мг/л. В этом случае проба воды должна быть разбавлена водой без содержания диоксида хлора. Добавьте реагент в 10 мл разбавленной пробы и повторите измерение (испытание на достоверность).

Выведено из

DIN 38408, раздел 5

⁹ требуется дополнительно для определения содержания брома, диоксида хлора и озона в присутствии хлора

KS4.3 T / 20

方法名称

方法号

用于方法检测的条形码

测量范围

酸性 / 指示剂

屏幕显示: MD 100 / MD 110 / MD 200

化学方法

儀器的具體信息

測試可以在以下設備上執行。此外還指出了所需的比色杯和光度計的吸收範圍。

儀器類型	比色皿	λ	測量範圍
MD 200, MD 600, MD 610, MD 640, MultiDirect, PM 620, PM 630	\varnothing 24 mm	610 nm	0.1 - 4 mmol/l $K_{S4.3}$
SpectroDirect, XD 7000, XD 7500	\varnothing 24 mm	615 nm	0.1 - 4 mmol/l $K_{S4.3}$

材料

所需材料 (部分可選) :

標題	包裝單位	貨號
Alka-M-Photometer	片劑 / 100	513210BT
Alka-M-Photometer	片劑 / 250	513211BT

應用列表

- 污水處理
- 飲用水處理
- 原水處理

備註

1. 術語總度-m、m-值、總碱度和酸容量 $K_{S4.3}$ 是相同的。
2. 準確地遵守 10 ml 的樣本體積對分析結果的準確度至關重要。

語言代碼 ISO 639-1

修訂狀態

CN 方法手冊 01/20

开始测量

进行测定 $K_{s4.3}$ 片剂酸容量

选择设备中的方法。

对于这种方法，在以下设备上不能进行 ZERO 测量：XD 7000, XD 7500

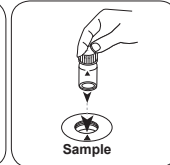
用 10 ml 样本填充 24 mm 比密封比色杯。
色杯。将样本比色杯放入测量轴
中。注意定位。

• • •

加入 ALKA-M-PHOTOME-
TER 片剂。

用轻微的扭转压碎片剂。

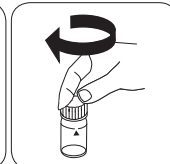

密封比色杯。

CN 方法手册 01/20

ZH



PP 二氧化氯

M122

0.04 - 3.8 mg/L ClO₂

CLO2

DPD

材料

所需材料 (部分可选) :

ZH

试剂	包装单位	货号
游离氯 DPD F10	粉剂 / 100 片	530100
游离氯 DPD F10	粉剂 / 1000 片	530103
甘氨酸 ⁹⁾	片剂 / 100	512170BT
甘氨酸 ⁹⁾	片剂 / 250	512171BT
VARIO 甘氨酸试剂 10 %, 29 毫升。	29 mL	532210

取样

1. 在样本制备中, 通过移液和摇动来避免的排气。
2. 取样后必须立即进行分析。

准备

1. 清洗比色杯 :
由于许多家用清洁剂 (例如洗碗用洗涤剂) 含有还原剂, 所以测定的二氧化氯结果可能会不足。为了排除这种测量误差, 玻璃器皿应无氯。为此, 将玻璃器皿在次氯酸钠溶液 (0.1 g/L) 下存放 1 小时, 然后用去离子水 (软化水) 彻底冲洗。
2. 在分析前 (用 0.5 mol/l 硫酸或 1 mol/l 氢氧化钠溶液) 必须将强碱性或酸性水的 pH 范围调节到 6 和 7 之间。

进行测定 Chlorine Dioxide, in absence of chlorine with powder packs

选择设备中的方法。

另外选择测定：without Chlorine

对于此方法，不必每次都在以下设备上 进行零测量：XD 7000, XD 7500



用 **10 mL** 样本填充 24 mm 比色杯。
密封比色杯。

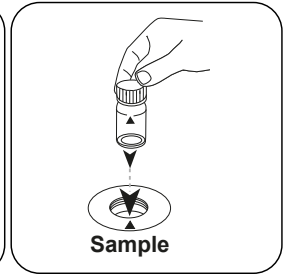
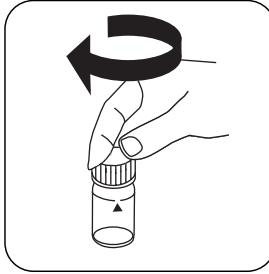

将样本比色杯放入测量轴中。注意定位。

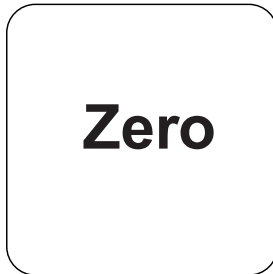

按下 **ZERO** 按钮。

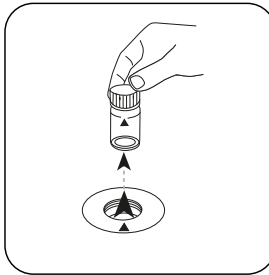

从测量轴上取下比色杯。

对于不需要 **ZERO** 测量的设备，从这里开始。

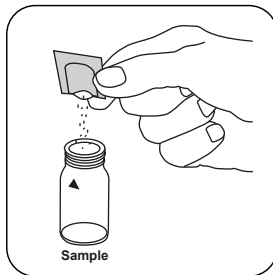

加入 **Chlorine FREE-DPD / F10** 粉包。
密封比色杯。

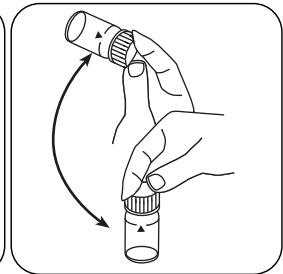
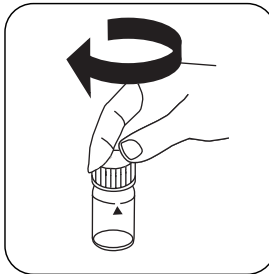

通过旋转混合内容物
(20 sec.) 。

ZH



ZH

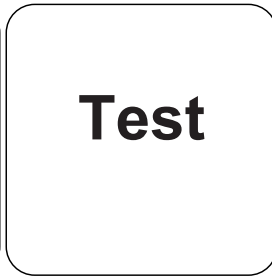
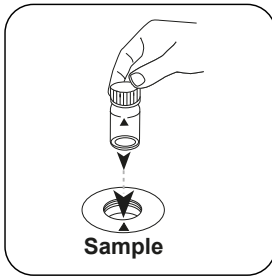

将**样本**比色杯放入测量轴中。注意定位。

按下 **TEST (XD: START)** 按钮。

结果在显示屏上显示为 mg / l 二氧化氯。

进行测定 Chlorine Dioxide, in presence of chlorine with powder packs

选择设备中的方法。

另外选择测定：in presence of Chlorine

对于此方法，不必每次都在以下设备上**进行零测量**：XD 7000, XD 7500



用 **10 mL** 样本填充 24 mm 比色杯。

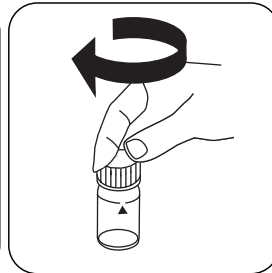

密封比色杯。

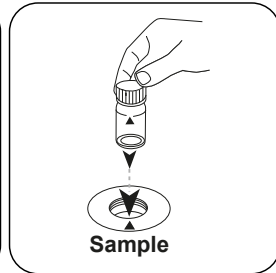

将**样本**比色杯放入测量轴中。注意定位。

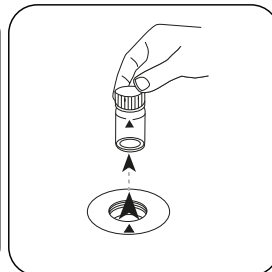
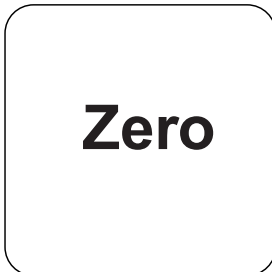

按下 **ZERO** 按钮。

从测量轴上取下比色杯。

对于不需要 **ZERO** 测量的设备，从这里开始。

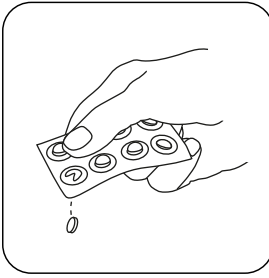

加入 **GLYCINE** 片剂。

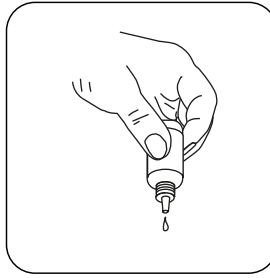

或加4滴**GLYCINE**
Reagent。

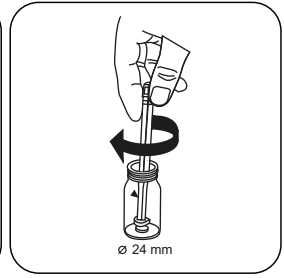

用轻微的扭转压碎片剂。

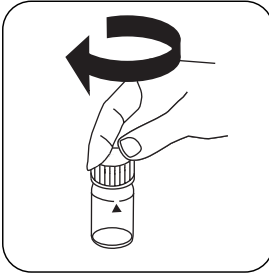

密封比色杯。

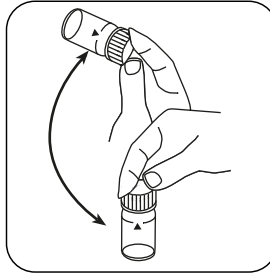

通过旋转溶解片剂。

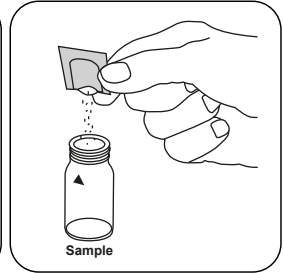

加入 **Chlorine-Free-DPD/
F10** 粉包。

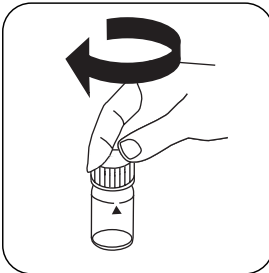

密封比色杯。

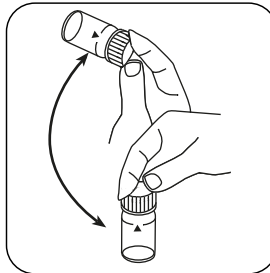

通过旋转混合内容物
(20 sec.)。

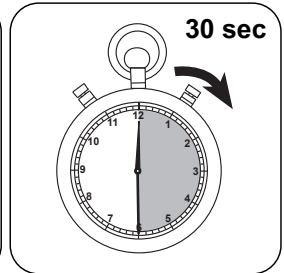

等待 **30 秒** 反应时间。

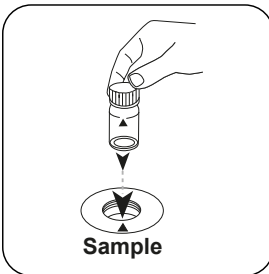

将样本比色杯放入测量轴
中。注意定位。

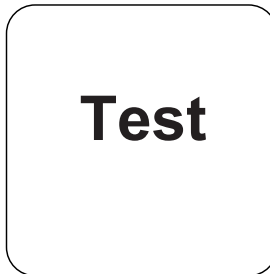

按下 **TEST (XD: START)** 按
钮。

结果在显示屏上显示为 mg / l 二氧化氯。



化学方法

DPD

附录

ZH

干扰说明

持续干扰

1. 存在于样本中的所有氧化剂都导致多重结果。

可消除干扰

1. 高于 3.8 mg/L 二氧化氯的浓度可导致测量范围内的结果高达 0 mg/L。在这种情况下应用不含二氧化氯的水稀释水样。将 10 ml 稀释的样本与试剂混合并重复测量（可信度测试）。

源于

DIN 38408, 第 5 部分

⁹ 附加试剂，用于含氯水样，进行溴，二氧化氯和臭氧的测定分析

Tintometer GmbH

Lovibond® Water Testing
Schleefstraße 8-12
44287 Dortmund
Tel.: +49 (0)231/94510-0
sales@lovibond.com
www.lovibond.com
Germany

Tintometer South East Asia

Unit B-3-12, BBT One Boulevard,
Lebuhr Nilam 2, Bandar Bukit Tinggi,
Klang, 41200, Selangor D.E
Tel.: +60 (0)3 3325 2285/6
Fax: +60 (0)3 3325 2287
lovibond.asia@tintometer.com
www.lovibond.com
Malaysia

Tintometer India Pvt. Ltd.

Door No: 7-2-C-14, 2nd, 3rd & 4th Floor
Sanathnagar Industrial Estate,
Hyderabad, 500018
Telangana
Tel: +91 (0) 40 23883300
Toll Free: 1 800 599 3891/ 3892
indiaoffice@lovibond.in
www.lovibondwater.in
India

The Tintometer Limited

Lovibond House
Sun Rise Way
Amesbury, SP4 7GR
Tel.: +44 (0)1980 664800
Fax: +44 (0)1980 625412
sales@lovibond.uk
www.lovibond.com
UK

Tintometer Brazil

Caixa Postal: 271
CEP: 13201-970
Jundiaí – SP
Tel.: +55 (11) 3230-6410
sales@lovibond.us
www.lovibond.com.br
Brazil

Tintometer Spain

Postbox: 24047
08080 Barcelona
Tel.: +34 661 606 770
sales@tintometer.es
www.lovibond.com
Spain

Tintometer China

9F, SOHO II C.
No.9 Guanghualu,
Chaoyang District,
Beijing, 100020
Customer Care China Tel.: 4009021628
Tel.: +86 10 85251111 Ext. 330
Fax: +86 10 85251001
chinaoffice@tintometer.com
www.lovibond.com
China

Tintometer Inc.

6456 Parkland Drive
Sarasota, FL 34243
Tel: 941.756.6410
Fax: 941.727.9654
sales@lovibond.us
www.lovibond.us
USA



Technical changes without notice
Printed in Germany 10/24

No.: 00386761

Lovibond® and Tintometer® are Trademarks of
the Tintometer Group of Companies

