

# Lovibond® Water Testing

Tintometer® Group



## Manual of Methods

MD50 • MD150

**EN MD50 Photometer**

Page 4

**ES Fotómetro MD50**

Página 8

**PT Fotómetro MD50**

Página 12

**NL MD50 Fotometer**

Zijde 16

**RU Фотометр MD50**

Страница 20

**DE MD50 Photometer**

Seite 6

**FR MD50 Photomètre**

Page 10

**IT Fotometro MD50**

Pagina 14

**TR MD50 fotometre**

Sayfa 18

**ZH MD50 光度计**

Page 22

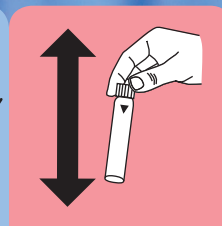
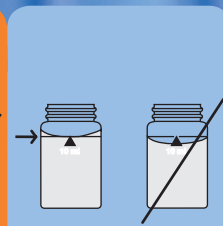



KS4.3 T / 20

Method name

Method number

Bar code for the detection of the methods

Measuring range

20

S:4.3

Chemical Method

Acid / Indicator

Display in the MD 100 / MD 110 / MD 200

**Instrument specific information**

The test can be performed on the following devices. In addition, the required cuvette and the absorption range of the photometer are indicated.

Instrument Type	Cuvette	λ	Measuring Range
MD 200, MD 600, MD 610, MD 640, MultiDirect, PM 620, PM 630	ø 24 mm	610 nm	0.1 - 4 mmol/l K <sub>S4.3</sub>
SpectroDirect, XD 7000, XD 7500	ø 24 mm	615 nm	0.1 - 4 mmol/l K <sub>S4.3</sub>

**Material**

Required material (partly optional):

Reagents	Packaging Unit	Part Number
Alka-M-Photometer	Tablet / 100	513210BT
Alka-M-Photometer	Tablet / 250	513211BT

**Application List**

- Waste Water Treatment
- Drinking Water Treatment
- Raw Water Treatment

**Notes**

1. The terms Alkalinity-m, m-Value, total alkalinity and Acid demand to K<sub>S4.3</sub> are identical.
2. For accurate results, exactly 10 ml of water sample must be used for the test.

Language codes ISO 639-1

Revision status

EN Handbook of Methods 01/20

**Performing test procedure**

**Implementation of the provision Acid capacity  $K_{S4.3}$  with Tablet**

Select the method on the device

For this method, no ZERO measurements are to be carried out with the following devices: XD 7000, XD 7500



Fill 24 mm vial with **10 ml sample**.



Close vial(s).

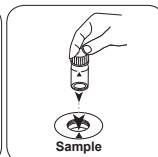

Place **sample vial** in the sample chamber. • Pay attention to the positioning.

• • •

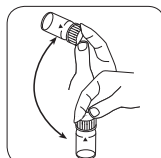

Dissolve tablet(s) by inverting.

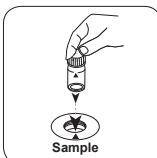

Place **sample vial** in the sample chamber. • Pay attention to the positioning.

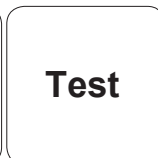

Press the **TEST (XD: START)** button.

The result in Acid Capacity  $K_{S4.3}$  appears on the display.

KS4.3 T / 20

Methoden Name

Methodennummer

Barcode zur Methodenerkennung

Messbereich

20

S:4.3

Säure / Indikator

Displayanzeige im MD 100 MD 110 / MD 200

Chemische Methode

**Instrumentenspezifische Informationen**

Der Test kann auf den folgenden Geräten durchgeführt werden. Zusätzlich sind die benötigte Küvette und der Absorptionsbereich der Photometer angegeben.

Geräte	Küvette	$\lambda$	Messbereich
MD 200, MD 600, MD 610, MD 640, MultiDirect, PM 620, PM 630	ø 24 mm	610 nm	0,1 - 4 mmol/l $K_{S4.3}$
SpectroDirect, XD 7000, XD 7500	ø 24 mm	615 nm	0,1 - 4 mmol/l $K_{S4.3}$

**Material**

Benötigtes Material (zum Teil optional):

Reagenzien	Form/Menge	Bestell-Nr.
Alka-M-Photometer	Tablette / 100	513210BT
Alka-M-Photometer	Tablette / 250	513211BT

**Anwendungsbereich**

- Abwasserbehandlung
- Trinkwasseraufbereitung
- Rohwasserbehandlung

**Anmerkungen**

1. Die Begriffe Alkalität-m, m-Wert, Gesamtalkalität und Säurekapazität  $K_{S4.3}$  sind identisch.
2. Die exakte Einhaltung des Probevolumens von 10 ml ist für die Genauigkeit des Analyseergebnisses entscheidend.

Sprachkürzel nach ISO 639-1

Revisionsstand

DE Methodenhandbuch 01/20

Durchführung der  
Messung**Durchführung der Bestimmung Säurekapazität  $K_{s4,3}$  mit Tablette**

Die Methode im Gerät auswählen.

Für diese Methode muss bei folgenden Geräten keine ZERO-Messung durchgeführt werden: XD 7000, XD 7500

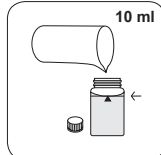
24-mm-Küvette mit **10 ml Probe** füllen.

Küvette(n) verschließen.

Die **Probeküvette** in den Messschacht stellen. Positionierung beachten.

• • •

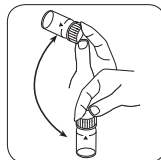

Tablette(n) durch Umschwenken lösen.

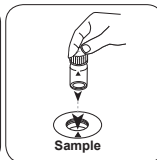
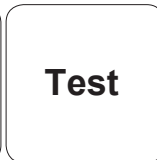
Die **Probeküvette** in den Messschacht stellen. Positionierung beachten.Taste **TEST** (XD: **START**) drücken.In der Anzeige erscheint das Ergebnis als Säurekapazität  $K_{s4,3}$ .

KS4.3 T / 20



**Nombre del método**

**Número de método**

**Código de barras para reconocer el método**

**Rango de medición**

$K_{S4.3} T$   
0.1 - 4 mmol/l  $K_{S4.3}$   
Ácido / Indicador

20  
S:4.3

**Método químico**

**Indicación en la pantalla de MD 100 / MD 110 / MD 200**

**Información específica del instrumento**

La prueba puede realizarse en los siguientes dispositivos. Además, se muestran la cubeta requerida y el rango de absorción del fotómetro.

Dispositivos	Cubeta	$\lambda$	Rango de medición
MD 200, MD 600, MD 610, MD 640, MultiDirect, PM 620, PM 630	$\varnothing$ 24 mm	610 nm	0.1 - 4 mmol/l $K_{S4.3}$
SpectroDirect, XD 7000, XD 7500	$\varnothing$ 24 mm	615 nm	0.1 - 4 mmol/l $K_{S4.3}$

**Material**

Material requerido (parcialmente opcional):

Título	Unidad de embalaje	Referencia No
Fotómetro alca-M	Tabletas / 100	513210BT
Fotómetro alca-M	Tabletas / 250	513211BT

**Lista de aplicaciones**

- Tratamiento de aguas residuales
- Tratamiento de aguas potables
- Tratamiento de aguas de aporte

**Notas**

1. Las definiciones de alcalinidad-m, valor-m y capacidad ácida  $K_{S4.3}$  son idénticas.
2. Añadir un volumen de muestra de exactamente 10 ml, ya que este volumen influye de forma decisiva en la exactitud del resultado.

**Códigos de idioma ISO 639-1**

**Estado de revisión**

ES Manual de Métodos 01/20

Realización de la determinación

Ejecución de la determinación Capacidad ácida  $K_{s4.3}$  con tableta

Seleccionar el método en el aparato.

Para este método no es necesario realizar medición CERO en los aparatos siguientes: XD 7000, XD 7500



Llenar la cubeta de 24 mm con 10 ml de muestra .



Cerrar la(s) cubeta(s).

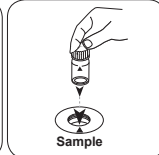

Poner la **cubeta de muestra** en el compartimiento de medición. ¡Debe tenerse en cuenta el posicionamiento!

• • •

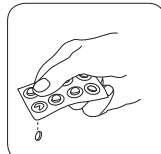

Añadir **tableta ALKA-M-PHOTOMETER**.

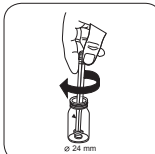

Triturar la(s) tableta(s) girando ligeramente.



Cerrar la(s) cubeta(s).



KS4.3 T / 20



**Nom de la méthode** → KS4.3 T

**Numéro de méthode** → 20

**Code à barres pour reconnaître la méthode** → [Barcode]

**Plage de mesure** → 0.1 - 4 mmol/l  $K_{S4.3}$

**Méthode chimique** → Acide / Indicateur

**Affichage dans le MD 100 / MD 110 / MD 200** → S:4.3

**Informations spécifiques à l'instrument**

Le test peut être effectué sur les appareils suivants. De plus, la cuvette requise et la plage d'absorption du photomètre sont indiquées.

Appareils	Cuvette	$\lambda$	Gamme de mesure
MD 200, MD 600, MD 610, MD 640, MultiDirect, PM 620, PM 630	ø 24 mm	610 nm	0.1 - 4 mmol/l $K_{S4.3}$
SpectroDirect, XD 7000, XD 7500	ø 24 mm	615 nm	0.1 - 4 mmol/l $K_{S4.3}$

**Matériel**

Matériel requis (partiellement optionnel):

Titre	Pack contenant	Code
Alka-M-Photometer	Pastilles / 100	513210BT
Alka-M-Photometer	Pastilles / 250	513211BT

**Liste d'applications**

- Traitement des eaux usées
- Traitement de l'eau potable
- Traitement de l'eau brute

**Indication**

1. Les termes Alcalinité-m, Valeur m, Alcalinité totale et Capacité acide  $K_{S4.3}$  sont identiques.
2. L'observation exacte du volume d'échantillon de 10 ml est décisive pour l'exactitude du résultat de l'analyse.

**Codes de langue ISO 639-1** → FR

**État de révision** → 01/20

FR Méthodes Manuel 01/20

## Procédure du test

**Réalisation de la quantification Capacité acide  $K_{s4.3}$  avec pastille**

Sélectionnez la méthode sur l'appareil.

Cette méthode ne nécessite aucune mesure du zéro sur les appareils suivants : XD 7000, XD 7500

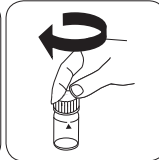
Remplissez une cuvette de 24 mm de **10 ml d'échantillon**.

Fermez la(les) cuvette(s).

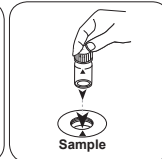
Placez la **cuvette réservée à l'échantillon** dans la chambre de mesure. Attention à la positionner correctement.

• • •

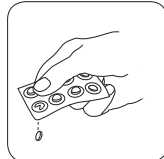
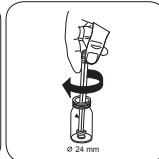
Ajoutez une **pastille de ALKA-M-PHOTOMETER**.

Écrasez la(les) pastille(s) en la(les) tournant un peu.

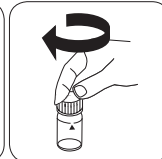

Fermez la(les) cuvette(s).

KS4.3 T / 20



**Nome do método**

**Número do método**

**Código de barras para a detecção dos métodos**

**Área de medição**

$K_{S_{4.3}} T$   
0.1 - 4 mmol/l  $K_{S_{4.3}}$   
Ácido / Indicador

20  
S:4.3

**Indicado no display: MD 100 / MD 110 / MD 200**

**Método Químico**

**Informação específica do instrumento**

O teste pode ser realizado nos seguintes dispositivos. Além disso, a cubeta necessária e a faixa de absorção do fotómetro são indicadas.

Dispositivos	Cubeta	$\lambda$	Faixa de Medição
MD 200, MD 600, MD 610, MD 640, MultiDirect, PM 620, PM 630	ø 24 mm	610 nm	0.1 - 4 mmol/l $K_{S_{4.3}}$
SpectroDirect, XD 7000, XD 7500	ø 24 mm	615 nm	0.1 - 4 mmol/l $K_{S_{4.3}}$

**Material**

Material necessário (parcialmente opcional):

Título	Unidade de Embalagem	Artigo No
Alka-M-Photometer	Pastilhas / 100	513210BT
Alka-M-Photometer	Pastilhas / 250	513211BT

**Lista de Aplicações**

- Tratamento de Esgotos
- Tratamento de Água Potável
- Tratamento de Água Bruta

**Notas**

1. Os termos alcalinidade-m, m-valor, alcalinidade total e capacidade de acidez  $K_{S_{4.3}}$  são idênticos.
2. O cumprimento exato do volume da amostra de 10 ml é decisivo para a precisão do resultado de análise.

**Códigos de idioma ISO 639-1**

**Nível de revisão**

PT Métodos Manual 01/20

Efetuar a medição

### Realização da determinação Capacidade de acidez $K_{s4.3}$ com pastilha

Escolher o método no equipamento.

Para este método não tem de ser efetuada uma medição ZERO nos seguintes equipamentos: XD 7000, XD 7500



Encher a célula de 24 mm com 10 ml de amostra .

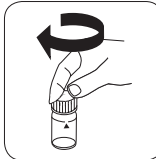

Fechar a(s) célula(s).

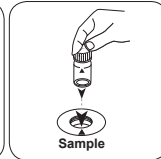

Colocar a **célula de amostra** no compartimento de medição. Observar o posicionamento.

• • •

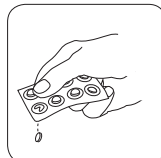

Pastilha ALKA-M-PHOTO-METER.

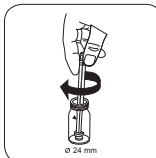

Esmagar a(s) pastilha(s) rodando ligeiramente.

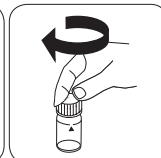

Fechar a(s) célula(s).

PT Métodos Manual 01/20

PT

KS4.3 T / 20



**Denominazione metodo**

**Numero metodo**

**Codice a barre per riconoscere il metodo**

**Range di misura**

$K_{S_{4.3} T}$   
0.1 - 4 mmol/l  $K_{S_{4.3}}$

20  
S:4.3

**Indicazione sul display del MD 100 / MD 110 / MD 200**

**Metodo chimico**

**Acido/indicatore**

**Informazioni specifiche dello strumento**

Il test può essere eseguito sui seguenti dispositivi. Inoltre, sono indicate la cuvetta richiesta e il range di assorbimento del fotometro.

Dispositivi	Cuvetta	$\lambda$	Campo di misura
MD 200, MD 600, MD 610, MD 640, MultiDirect, PM 620, PM 630	ø 24 mm	610 nm	0.1 - 4 mmol/l $K_{S_{4.3}}$
SpectroDirect, XD 7000, XD 7500	ø 24 mm	615 nm	0.1 - 4 mmol/l $K_{S_{4.3}}$

**Materiale**

Materiale richiesto (in parte facoltativo):

Titolo	Unità di imballaggio	N. ordine
Alka-M-Photometer	Pastiglia / 100	513210BT
Alka-M-Photometer	Pastiglia / 250	513211BT

**Campo di applicazione**

- Trattamento acqua di scarico
- Trattamento acqua potabile
- Trattamento acqua non depurata

**Note**

1. I termini alcalinità M, valore M, alcalinità totale e capacità acida  $K_{S_{4.3}}$  sono equivalenti.
2. Per l'accuratezza del risultato dell'analisi è fondamentale che il volume del campione misuri esattamente 10 ml.

**ISO 639-1 codici linguistici**

**Stato di revisione**

IT Manuale dei Metodi 01/20

**Svolgimento della misurazione**

**Esecuzione della rilevazione Capacità acida  $K_{s4,3}$  con pastiglia**

Selezionare il metodo nel dispositivo.

Con i seguenti dispositivi, per questo metodo non è necessario eseguire una misurazione ZERO: XD 7000, XD 7500



Riempire una cuvetta da 24 mm con **10 ml di campione**.



Chiudere la/e cuvetta/e.

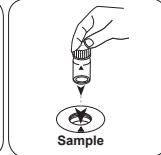

Posizionare la **cuvetta del campione** nel vano di misurazione. Fare attenzione al posizionamento.

• • •

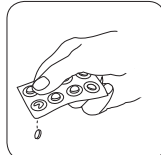

Aggiungere una **pastiglia ALKA-M-PHOTOMETER**.

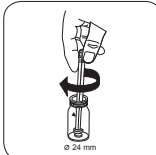

Frantumare la/e pastiglia/e con una leggera rotazione.

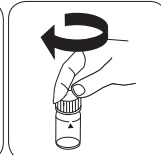

Chiudere la/e cuvetta/e.

KS4.3 T / 20



**Naam van de methode**

**Nummer methode**

**Streepjescode ter identificatie van de methode**

**Meetbereik**

$K_{S_{4.3}} T$  M20  
0.1 - 4 mmol/l  $K_{S_{4.3}}$  S:4.3  
Zuur / Indicator

**Chemische methode**

**Uitlezing in MD**  
100 MD 110 / MD  
200

**Instrument specifieke informatie**

De test kan op de volgende apparaten worden uitgevoerd. Bovendien worden de vereiste cuvette en het absorptiebereik van de fotometer aangegeven.

Toestellen	Cuvet	$\lambda$	Meetbereik
MD 200, MD 600, MD 610, MD 640, MultiDirect, PM 620, PM 630	$\varnothing$ 24 mm	610 nm	0.1 - 4 mmol/l $K_{S_{4.3}}$
SpectroDirect, XD 7000, XD 7500	$\varnothing$ 24 mm	615 nm	0.1 - 4 mmol/l $K_{S_{4.3}}$

**Reagentia**

Benodigd materiaal (deels optioneel):

Titel	Verpakkingseenheid	Bestelnr.
Alka-M-Photometer	Tablet / 100	513210BT
Alka-M-Photometer	Tablet / 250	513211BT

**Toepassingsbereik**

- Afvalwaterzuivering
- Behandeling drinkwater
- Zuivering vervuild water

**Aantekeningen**

1. De termen alkaliteit-m, m-waarde, totale alkaliteit en zuurcapaciteit<sub>S<sub>4.3</sub></sub> zijn identiek.
2. De exacte naleving van het monstervolume van 10 ml is bepalend voor de nauwkeurigheid van het analysesresultaat.

**Beknopte naam conform de norm ISO 639-1**

**Herziene versie**

NL Handboek van Methoden 01/20

**Uitvoering van de meting**

**Uitvoering van de bepaling Zuurcapaciteit  $K_{s4,3}$  met tablet**

De methode in het apparaat selecteren.

Voor deze methode moet bij de volgende apparaten geen nulmeting worden uitgevoerd:  
XD 7000, XD 7500



Spoelbakje van 24 mm met **10 ml staal** vullen.



De spoelbakjes afsluiten.



Het **staal spoelbakje** in de meetschacht plaatsen. Op de positionering letten.

• • •



Tabletten oplossen door om te draaien



Het **staal spoelbakje** in de meetschacht plaatsen. Op de positionering letten.



De toets **TEST** (XD: **START**) indrukken.

De display toont het resultaat als Zuurcapaciteit  $K_{s4,3}$ .



KS4.3 T / 20

Yöntem Adı

Yöntemleri numarası

Yöntemi tanımak için barkod

Ölçüm aralığı

Kimyasal Metod

$K_{S4.3} T$   
0.1 - 4 mmol/l  $K_{S4.3}$   
Asit / Gösterge

20  
S:4.3

Ekrandaki: MD  
100 MD 110 / MD  
200

**Enstrümana özel bilgi**

Test, aşağıdaki cihazlarda gerçekleştirilebilir. Ek olarak, gerekli küvet ve fotometrenin emilim aralığı belirtilmiştir.

Cihazlar	Küvet	$\lambda$	Ölçüm Aralığı
MD 200, MD 600, MD 610, MD 640, MultiDirect, PM 620, PM 630	ø 24 mm	610 nm	0.1 - 4 mmol/l $K_{S4.3}$
SpectroDirect, XD 7000, XD 7500	ø 24 mm	615 nm	0.1 - 4 mmol/l $K_{S4.3}$

**Malzeme**

Gerekli materyal (kısmen isteğe bağlı):

Başlık	Paketleme Birimi	Ürün No
Alka-M-Photometer	Tablet / 100	513210BT
Alka-M-Photometer	Tablet / 250	513211BT

**Uygulama Listesi**

- Atık Su Arıtma
- İçme Suyu Arıtma
- Ham Su Arıtma

**Notlar**

1. Alkalite-m, m değeri, toplam alkalite ve asit kapasitesi  $K_{S4.3}$  kavramları ayrıdır.
2. 10 ml'lik numune hacmine tam riayet edilmesi, analiz sonucunun doğruluğu bakımından önemlidir.

Dil kodları ISO  
639-1

Revizyon durumu

TR Metotlar Kılavuzu 01/20

**Testin uygulanması**

**Tespitin uygulanması Tabletli asit kapasitesi  $K_{S4,3}$**

Cihazda metot seçin.

Bu metot için şu cihazlarda ZERO ölçümü yapılması gerekmez: XD 7000, XD 7500



24 mm'lik küveti **10 ml numune** ile doldurun.

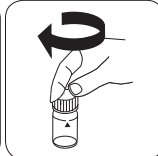

Küveti(küvetleri) kapatın.

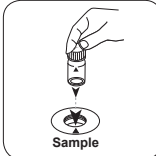

**Numune küvetini** ölçüm haznesine koyun. Doğru konumlandırılmasına dikkat edin.

• • •

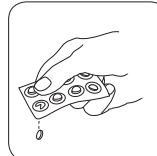

**ALKA-M-PHOTOMETER tablet** ilave edin.

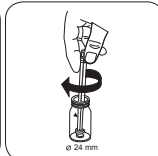

Tableti(tabletleri) hafifçe döndürerek ezin.

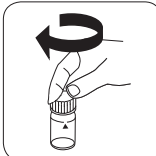

Küveti(küvetleri) kapatın.

KS4.3 T / 20



**Название метода** → KS4.3 T

**Номер метода** → M20

**Штрих-код для распознавания метода** → [Barcode]

**Диапазон измерений** → 0.1 - 4 mmol/l  $K_{S4.3}$

**Химический метод** → Кислота / индикатор

**Отображение на дисплее в MD 100 MD 110 / MD 200** → S:4.3

**Специфическая информация об инструменте**

Тест может быть выполнен на следующих устройствах. Кроме того, указывается требуемая кювета и диапазон поглощения фотометра.

Приборы	Кювета	$\lambda$	Диапазон измерений
MD 200, MD 600, MD 610, MD 640, MultiDirect, PM 620, PM 630	ø 24 mm	610 nm	0.1 - 4 mmol/l $K_{S4.3}$
SpectroDirect, XD 7000, XD 7500	ø 24 mm	615 nm	0.1 - 4 mmol/l $K_{S4.3}$

**Материал**

Необходимый материал (частично необязательный):

Заголовок	Упаковочная единица	Номер заказа
Alka-M-Photometer	Таблетка / 100	513210BT
Alka-M-Photometer	Таблетка / 250	513211BT

**Область применения**

- Обработка сточных вод
- Подготовка питьевой воды
- Обработка сырой воды

**Примечания**

1. Термины Щелочность M, m-значение, общая калийность и кислотная сила  $K_{S4.3}$  идентичны.
2. Точное соблюдение объема пробы в 10 мл имеет решающее значение для точности результатов анализа.

**Сокращенное обозначение языка в соответствии с ISO 639-1** → RU

**Статус редакции** → 01/20

RU Методическое руководство 01/20

**Выполнение  
измерения**
**Выполнение определения Кислотная сила  $K_{s4.3}$  с таблеткой**

Выберите метод в устройстве.

Для этого метода измерения нуля не требуется для следующих устройств: XD 7000, XD 7500



24-Наполните ковеву -мм  
10 пробой мл.



Закройте ковеву(ы).

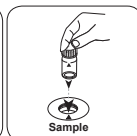

Поместите ковеву для  
проб в измерительную  
шахту. Обращайте  
внимание на  
позиционирование.

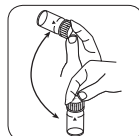

Растворите таблетку  
(таблетки) покачиванием.

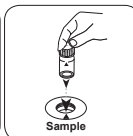

Поместите ковеву для  
проб в измерительную  
шахту. Обращайте  
внимание на  
позиционирование.



Нажмите клавишу TEST  
(XD: СТАРТ).

На дисплее отображается результат в виде Кислотная сила  $K_{s4.3}$ .

KS4.3 T / 20

方法名称

方法号

用于方法检测的条形码

测量范围

酸性 / 指示剂

屏幕显示: MD 100 / MD 110 / MD 200

化学方法

语言代码ISO 639-1

修订状态

**KS<sub>4.3</sub> T**      **20**

**0.1 - 4 mmol/l K<sub>S4.3</sub>**      **S:4.3**

**酸性 / 指示剂**

**儀器的具體信息**

測試可以在以下設備上執行。此外還指出了所需的比色杯和光度計的吸收範圍。

儀器類型	比色皿	λ	測量範圍
MD 200, MD 600, MD 610, MD 640, MultiDirect, PM 620, PM 630	ø 24 mm	610 nm	0.1 - 4 mmol/l K <sub>S4.3</sub>
SpectroDirect, XD 7000, XD 7500	ø 24 mm	615 nm	0.1 - 4 mmol/l K <sub>S4.3</sub>

**材料**

所需材料 (部分可選) :

標題	包裝單位	貨號
Alka-M-Photometer	片劑 / 100	513210BT
Alka-M-Photometer	片劑 / 250	513211BT

**應用列表**

- 污水處理
- 飲用水處理
- 原水處理

**備註**

1. 術語總度-m、m-值、總碱度和酸容量 K<sub>S4.3</sub> 是相同的。
2. 準確地遵守 10 ml 的樣本體積對分析結果的準確度至關重要。

CN 方法手冊 01/20

开始测量

进行测定  $K_{s4.3}$  片剂酸容量

选择设备中的方法。

对于这种方法，在以下设备上不能进行 ZERO 测量：XD 7000, XD 7500

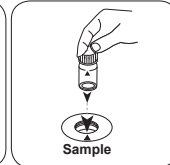
用 10 ml 样本填充 24 mm 比密封比色杯。  
色杯。将样本比色杯放入测量轴  
中。注意定位。

• • •

加入 ALKA-M-PHOTOME-  
TER 片剂。

用轻微的扭转压碎片剂。

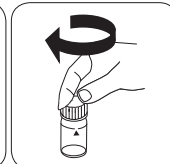

密封比色杯。

CN 方法手册 01/20

ZH











**Tintometer GmbH**

Lovibond® Water Testing  
Schleefstraße 8-12  
44287 Dortmund  
Tel.: +49 (0)231/94510-0  
sales@lovibond.com  
www.lovibond.com  
Germany

**Tintometer South East Asia**

Unit B-3-12, BBT One Boulevard,  
Lebuh Nilam 2, Bandar Bukit Tinggi,  
Klang, 41200, Selangor D.E  
Tel.: +60 (0)3 3325 2285/6  
Fax: +60 (0)3 3325 2287  
lovibond.asia@tintometer.com  
www.lovibond.com  
Malaysia

**Tintometer India Pvt. Ltd.**

Door No: 7-2-C-14, 2<sup>nd</sup>, 3<sup>rd</sup> & 4<sup>th</sup> Floor  
Sanathnagar Industrial Estate,  
Hyderabad, 500018  
Telangana  
Tel: +91 (0) 40 23883300  
Toll Free: 1 800 599 3891/ 3892  
indiaoffice@lovibond.in  
www.lovibondwater.in  
India

**The Tintometer Limited**

Lovibond House  
Sun Rise Way  
Amesbury, SP4 7GR  
Tel.: +44 (0)1980 664800  
Fax: +44 (0)1980 625412  
sales@lovibond.uk  
www.lovibond.com  
UK

**Tintometer Brazil**

Caixa Postal: 271  
CEP: 13201-970  
Jundiaí – SP  
Tel.: +55 (11) 3230-6410  
sales@lovibond.us  
www.lovibond.com.br  
Brazil

**Tintometer Spain**

Postbox: 24047  
08080 Barcelona  
Tel.: +34 661 606 770  
sales@tintometer.es  
www.lovibond.com  
Spain

**Tintometer China**

9F, SOHO II C.  
No.9 Guanghualu,  
Chaoyang District,  
Beijing, 100020  
Customer Care China Tel.: 4009021628  
Tel.: +86 10 85251111 Ext. 330  
Fax: +86 10 85251001  
chinaoffice@tintometer.com  
www.lovibond.com  
China

**Tintometer Inc.**

6456 Parkland Drive  
Sarasota, FL 34243  
Tel: 941.756.6410  
Fax: 941.727.9654  
sales@lovibond.us  
www.lovibond.us  
USA



Technical changes without notice  
Printed in Germany 10/24

No.: 00386769

Lovibond® and Tintometer® are Trademarks of  
the Tintometer Group of Companies

